

HOMSO 雄塑®



2018
HOMSO
product catalogue

PP-R

Green Superior Pipe for Household



CONTACT US



WWW.XIONGSU.CN



gdxs@xionsu.cn



0757-86518888



PP-R Pipe Series S5
Color: White, Green, White and green
• For Cold Water

O.D. (mm)	Thickness (mm)	Pressure (Mpa)
20	2	1.25
25	2.3	1.25
32	2.9	1.25

PP-R Pipe Series S3.2
Color: White, Green, White and green
• For Cold and Hot Water

O.D. (mm)	Thickness (mm)	Pressure (Mpa)
20	2.8	2
25	3.5	2
32	4.4	2

PP-R Pipe Series S4
Color: White, Green, White and green
• For Cold Water

O.D. (mm)	Thickness (mm)	Pressure (Mpa)
20	2.3	1.6
25	2.8	1.6
32	3.6	1.6

PP-R Pipe Series S2.5
Color: White, Green, White and green
• For Cold and Hot Water

O.D. (mm)	Thickness (mm)	Pressure (Mpa)
20	3.4	2.5
25	4.2	2.5
32	5.4	2.5

Coupling

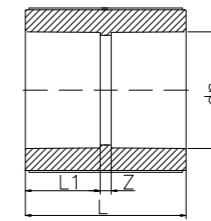

Size (mm)	L (mm)	L1 (mm)	Z (mm)
20	37	17	3
25	41	19	3
32	46	21	4

90° Elbow

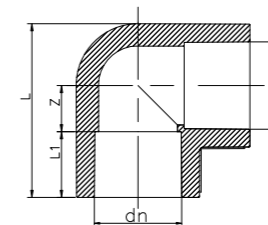

Size (mm)	L (mm)	L1 (mm)	Z (mm)
20	43.7	17	12
25	51.2	19	14.5
32	61	21	17.5

90° Equal Tee

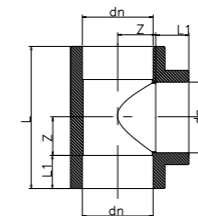
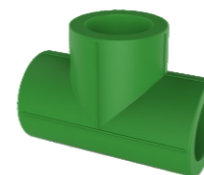

Size (mm)	L (mm)	L1 (mm)	Z (mm)
20	58	17	12
25	67	19	14.5
32	77	21	17.5

90° Reducing Tee

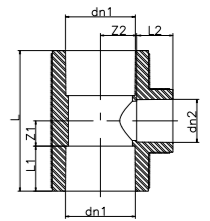
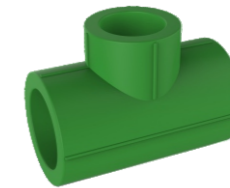

Size (mm)	L (mm)	L1 (mm)	L2 (mm)	Z1 (mm)	Z2 (mm)
25x20	59	19	17	10.5	12.5
32x20	64	21	17	11	16
32x25	68.5	21	19	13.25	16.5

90° Reducing Elbow

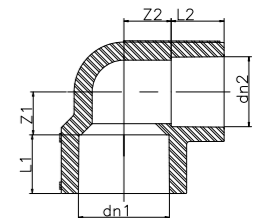

Size (mm)	L1 (mm)	Z1 (mm)	L2 (mm)	Z2 (mm)
25x20	19	12	17	13.5
32x20	21	13	17	17
32x25	21	15	19	16.5

45° Elbow

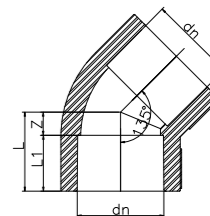

Size (mm)	L (mm)	L1 (mm)	Z (mm)
20	23.5	17	6.5
25	26.5	19	7.5
32	30.5	21	9.5

Reducer

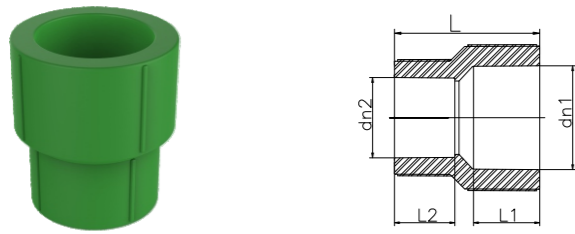

Size (mm)	L (mm)	L1 (mm)	L2 (mm)
25x20	39.5	19	17
32x20	43.5	21	17
32x25	44.5	21	19

Cap



Size (mm)	L (mm)	L1 (mm)
20	24	16.5
25	27.5	18.5
32	31.5	20.5

Male Thread Plug

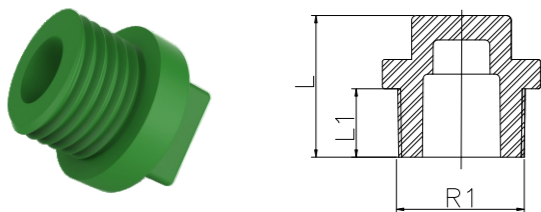

Size (mm)	L (mm)	L1 (mm)
R1/2"	26	13
R3/4"	29	14
R1"	34	16

Straight Cross

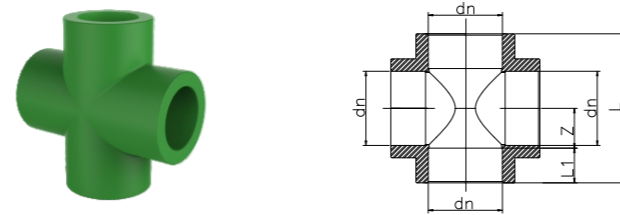

Size (mm)	L (mm)	L1 (mm)	Z (mm)
20	58	17	12
25	67	19	14.5
32	77	21	17.5

Female Coupling (Copper Thread) I

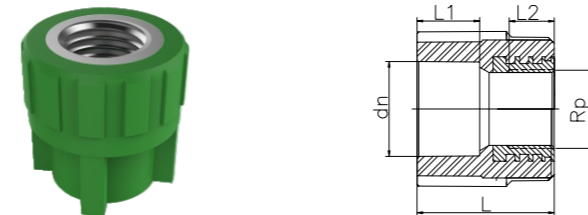

Size (mm)	L (mm)	L1 (mm)	L2 (mm)
20x1/2"	42.6	17	14.5
20x3/4"	44	17	15
25x1/2"	44	19	14.5
25x3/4"	45	19	15
25x1"	59	19	16.5
32x1/2"	45	21	14.5
32x3/4"	46	21	15

Female Coupling (Copper Thread) II

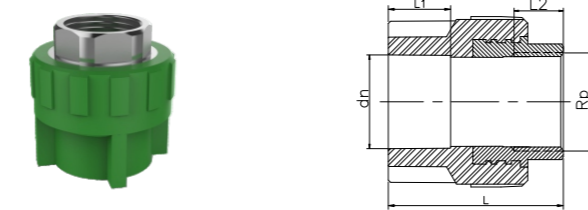

Size (mm)	L (mm)	L1 (mm)	L2 (mm)
32x1"	59	21	16.5

Male Coupling (Copper Thread) I

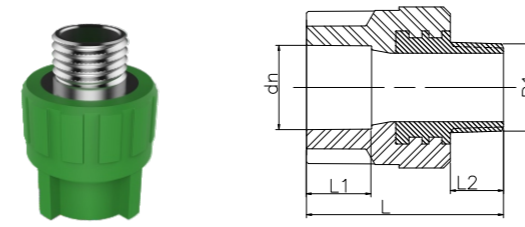

Size (mm)	L (mm)	L1 (mm)	L2 (mm)
20x1/2"	54	17	13.5
20x3/4"	57	17	14.5
25x1/2"	57	19	13.5
25x3/4"	57	19	14.5
25x1"	77.5	19	17
32x1/2"	58.5	21	13.5
32x3/4"	59	21	14.5

Male Coupling (Copper Thread) II

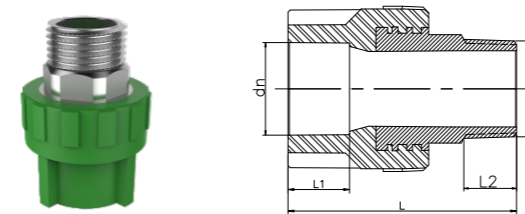

Size (mm)	L (mm)	L1 (mm)	L2 (mm)
32x1"	77.5	21	20.5

Female Elbow (Copper Thread) I

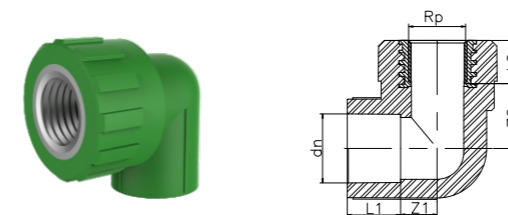

Size (mm)	L1 (mm)	Z1 (mm)	L2 (mm)	Z2 (mm)
20x1/2"	17	12	14.5	21.5
20x3/4"	17	15	15	21
25x1/2"	19	13	14.5	24
25x3/4"	19	14	15	24
32x1/2"	21	14	14.5	29
32x3/4"	21	15	15	29.5

Female Elbow (Copper Thread) II

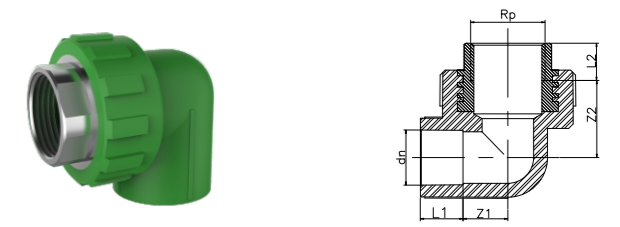

Size (mm)	L1 (mm)	Z1 (mm)	L2 (mm)	Z2 (mm)
32x1"	21	20	16.5	34.5

Male Elbow (Copper Thread) I



Size (mm)	L1 (mm)	Z1 (mm)	L2 (mm)	Z2 (mm)
20x1/2"	17	11.5	13.5	36.3
20x3/4"	17	14	14.5	36
25x1/2"	19	12	13.5	38.3
25x3/4"	19	13.25	14.5	39
25x1"	19	20	17	49.6
32x1/2"	21	14	13.5	43
32x3/4"	21	14	14.5	44

Male Elbow (Copper Thread) II



Size (mm)	L1 (mm)	Z1 (mm)	L2 (mm)	Z2 (mm)
32x1"	21	20	17	54.8

Female Tee (Copper Thread) I

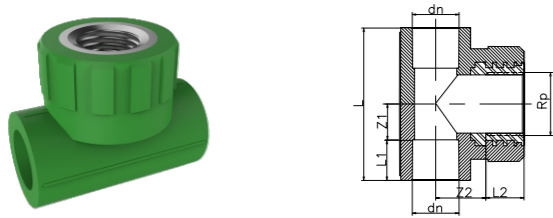

Size (mm)	L (mm)	L1 (mm)	L2 (mm)	Z1 (mm)	Z2 (mm)
20x1/2"	58	17	14.5	12	21.5
20x3/4"	64	17	15	15	22
25x1/2"	64	19	14.5	13	24
25x3/4"	65.5	19	15	13.75	24
32x1/2"	70	21	14.5	14	29
32x3/4"	72	21	15	15	29.5

Female Tee (Copper Thread) II

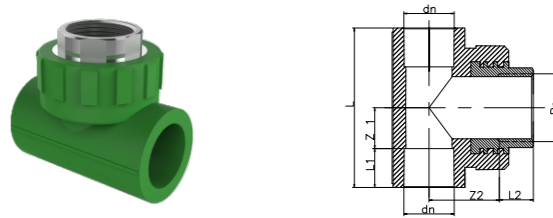

Size (mm)	L (mm)	L1 (mm)	L2 (mm)	Z1 (mm)	Z2 (mm)
32x1"	82	21	16.5	20	39.5

Male Tee (Copper Thread) I

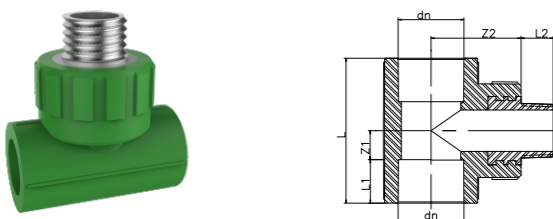

Size (mm)	L (mm)	L1 (mm)	L2 (mm)	Z1 (mm)	Z2 (mm)
20x1/2"	57	17	13.5	11.5	36.4
20x3/4"	62	17	14.5	14	36.9
25x1/2"	62	19	13.5	12	38.4
25x3/4"	64.5	19	14.5	13.25	38.9
32x1/2"	70	21	13.5	14	43
32x3/4"	70	21	14.5	14	44.4

Male Tee (Copper Thread) II

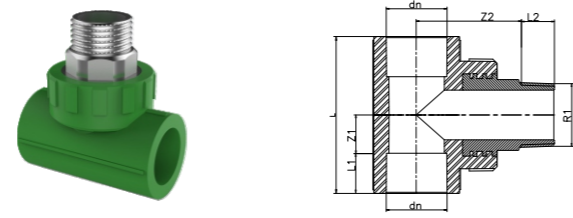

Size (mm)	L (mm)	L1 (mm)	L2 (mm)	Z1 (mm)	Z2 (mm)
32x1"	82	21	17	20	54.8

Female Thread Elbow With Seat

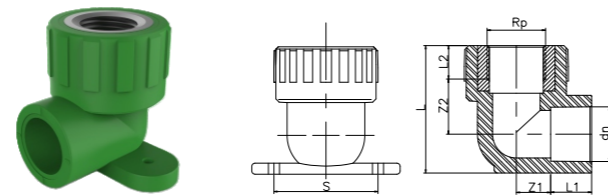

Size (mm)	L (mm)	L1 (mm)	Z1 (mm)	S (mm)	L2 (mm)	Z2 (mm)
20x1/2"	50	16.5	12.5	39	15	21
20x3/4"	50	16.5	13.5	39	15	21
25x1/2"	57.5	18.5	12.5	47	15	42.5
25x3/4"	57.5	18.5	15.5	47	15	42.5

Male Thread Elbow With Seat

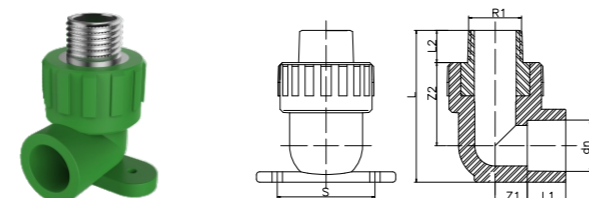

Size (mm)	L (mm)	L1 (mm)	Z1 (mm)	S (mm)	L2 (mm)	Z2 (mm)
20x1/2"	65	16.5	12.5	39	15	36
20x3/4"	65	16.5	13.5	39	15	36
25x1/2"	72.5	18.5	12.5	47	15	40
25x3/4"	72.5	18.5	15.5	47	15	40

Double Female Thread Tee with Seat

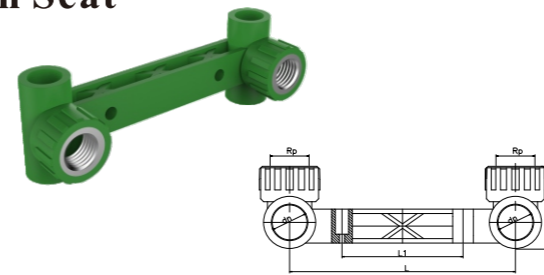

Size (mm)	L (mm)	L1 (mm)	H (mm)
20x1/2"	153	82	48.5
25x1/2"	153	82	55.6

Double Female Thread Elbow with Seat

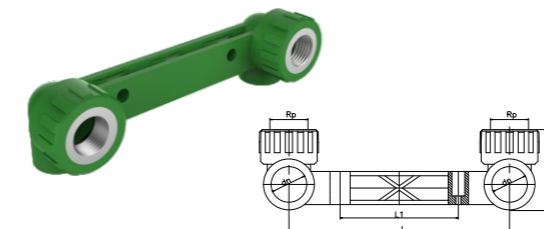

Size (mm)	L (mm)	L1 (mm)	H (mm)
20x1/2"	153	82	48.5
25x1/2"	153	82	55.6

Female Thread Union

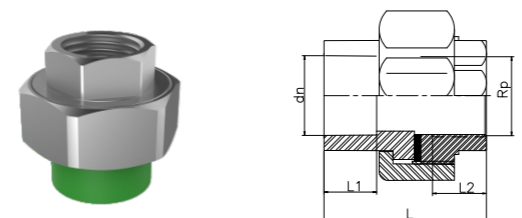

Size (mm)	L (mm)	L1 (mm)	L2 (mm)
20x1/2"	39	16.5	15
25x3/4"	43.8	18.5	15
32x1"	48	20.5	20.5

Male Thread Union

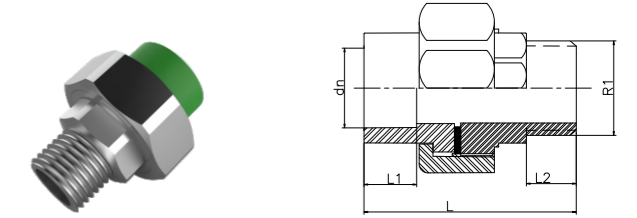

Size (mm)	L (mm)	L1 (mm)	L2 (mm)
20x1/2"	52	16.5	15
25x3/4"	57.5	18.5	15
32x1"	65.5	20.5	20.5

Stop Valve

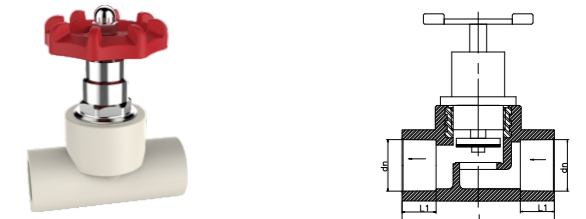

Size (mm)	L (mm)	L1 (mm)
20	70	17
25	80	19
32	85	21

Ball Valve

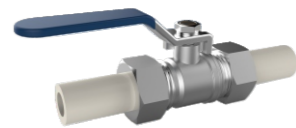

Size (mm)
20
25
32

True Union Ball Valve

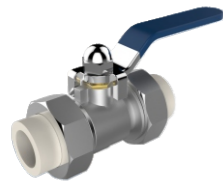

Size (mm)
20
25
32

Male Thread Union Ball Valve

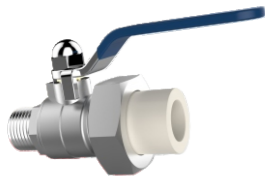

Size (mm)
20x1/2"
25x3/4"
32x1"

Female Thread Union Ball Valve

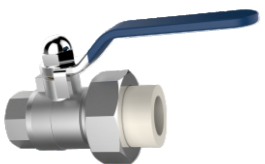

Size (mm)
20x1/2"
25x3/4"
32x1"

Flexible Joint I

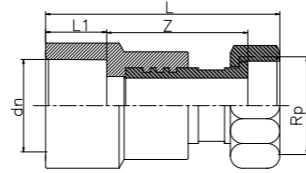
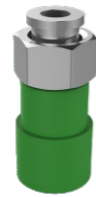

Size (mm)	L (mm)	L1 (mm)	Z (mm)
20x1/2"	68.6	16.5	43.5
20x3/4"	69.1	16.5	43.8
25x1/2"	70.6	18.5	43.5
25x3/4"	71.3	18.5	44
32x1"	79.5	20.5	48.5

Union II

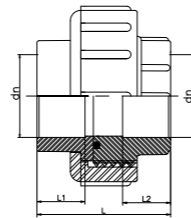

Size (mm)	L (mm)	L1 (mm)	L2 (mm)
20	55	17	17
25	62	19	19
32	74	21	21

Pipe Clamp (Screw)

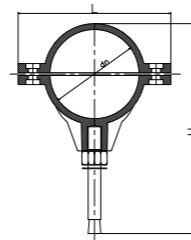

Size (mm)	L (mm)	H (mm)
20	50	90
25	57	101
32	64	118

Pipe Clamp with Steel Nail

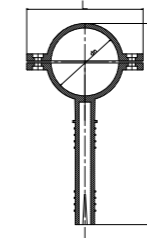

Size (mm)	L (mm)	H (mm)
20	50	110
25	57	105
32	64	113

Pipe Clamp

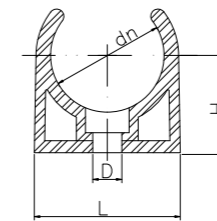

Size (mm)	L (mm)	H (mm)	D (mm)
20	28	20.5	8
25	33	23	8
32	40	26.8	8

Pipe Bending I

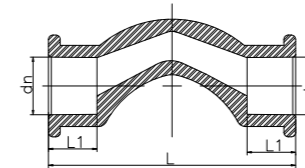

Size (mm)	L (mm)	L1 (mm)
20	84	16.5
25	95	18.5
32	120	21

Pipe Bending II

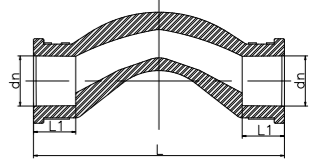

Size (mm)	L (mm)	L1 (mm)
20	98	16.5
25	125	18.5
32	140	21

Pipe Bending (Cold Water)

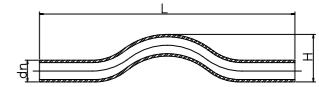

Size (mm)	L (mm)	H (mm)
20	215	45
25	325	50
32	315	65

Pipe Bending (Hot Water)

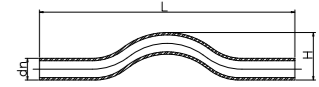

Size (mm)	L (mm)	H (mm)
20	215	45
25	325	50
32	315	65

Welding Step

1. Clean the pipe socket and the fittings socket surface.
2. Mark the insertion end of the pipe.
3. Heating the pipes and fittings to be connected with a hot melt machine.
4. Inserting the pipe into the fittings uniformly and steadily after the heating is finished.
5. The cooling time shall should match the size of the pipe, the cooling time of the large size and specification shall be appropriately extended according to the actual situation on the spot.

The welding is subject to the following data

O.D. (mm)	Welding Depth (mm)	Heating Time (s)	Welding Time (s)	Cooling Time (min)
20	14	5	4	2
25	16	7	4	2
32	18.5	8	6	4
40	20	12	6	4
50	23	18	6	4
63	27	24	8	6
75	29	30	8	8
90	33.5	40	8	8
110	39.5	50	10	8

● If the ambient temperature is below 5 °C, the heating time should be extended by 50%.

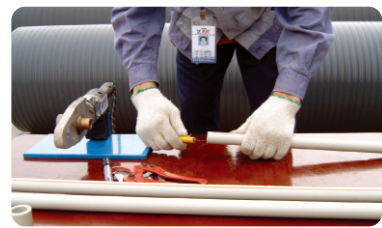

Clean



Mark



Heating



Welding



Cooling



Complete