

HOMSO 雄塑®

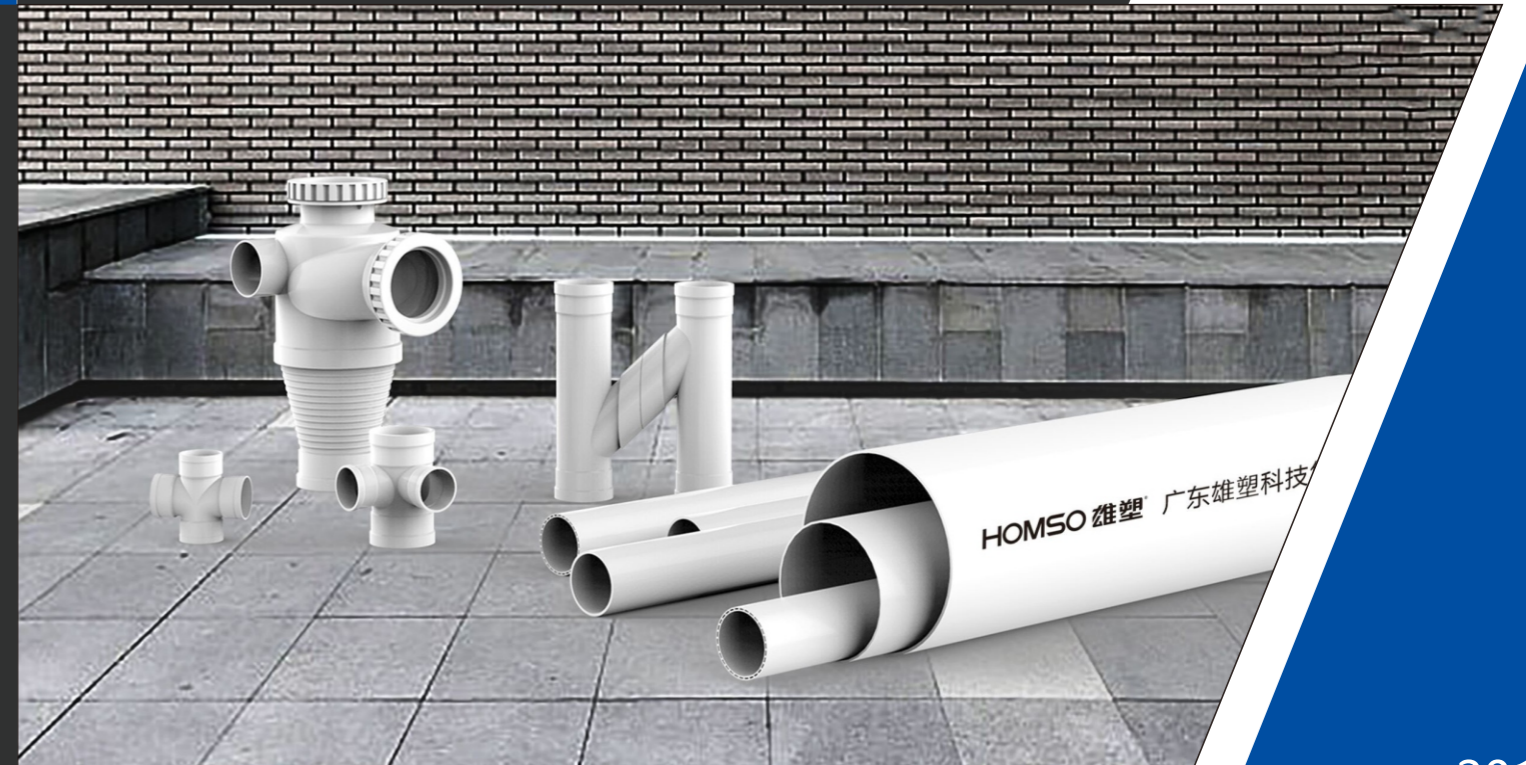

# PVC-U

## Drainage Pipe and Fittings

2018  
HOMSO  
product catalogue



### CONTACT US



WWW.XIONGSU.CN



gdxs@xionsu.cn



0757-86518888

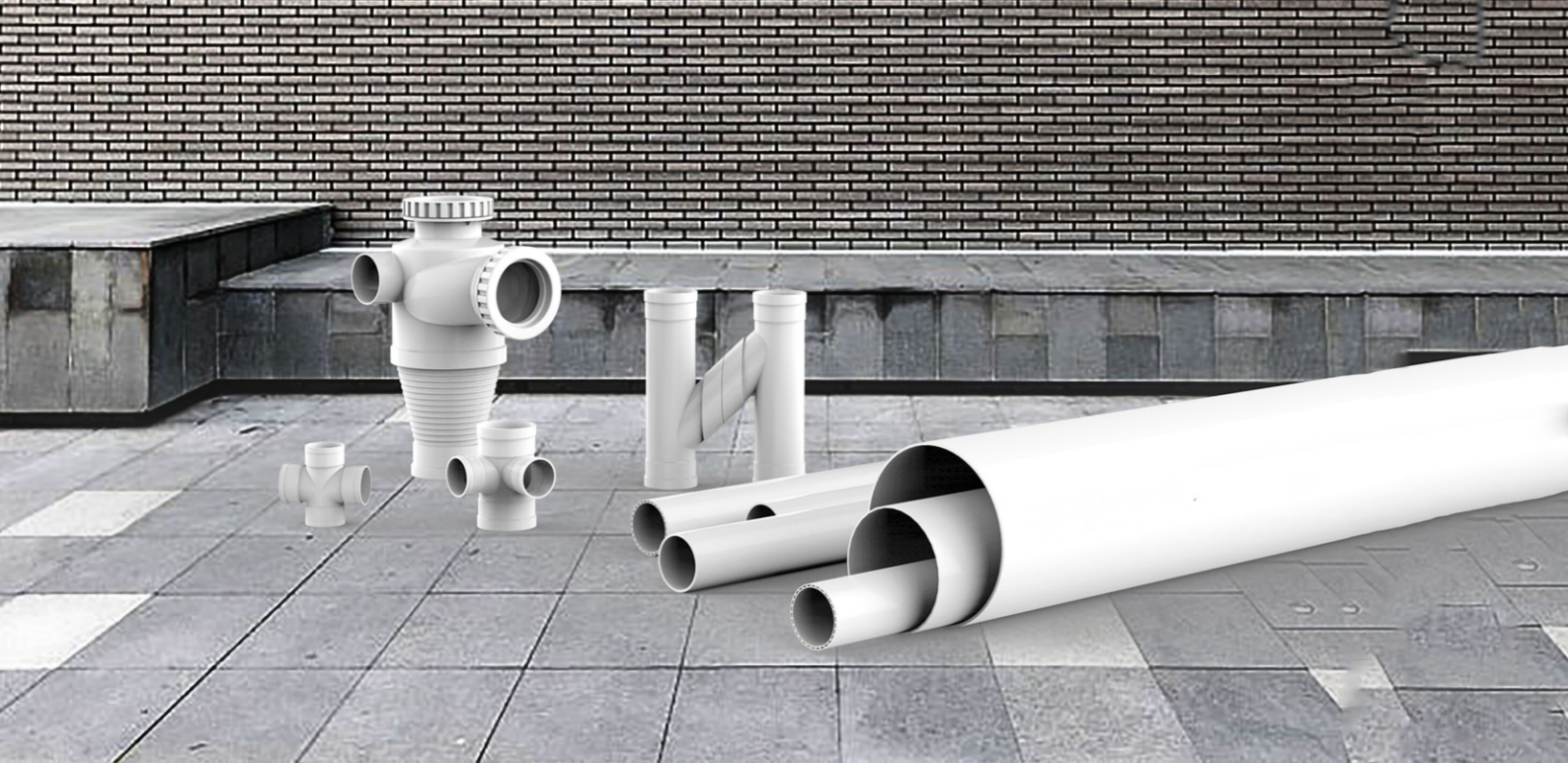

**Coupling**

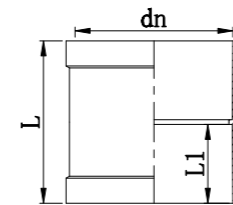

Size (mm)	L (mm)	L1 (mm)
32	51.5	25
40	54	25
50	52	25
75	82	40
90	93	45
110	100	48.5
160	120	58.5
200	140	68.5
250	162	78.5
315	224	110.5

**Sanitary Tee**

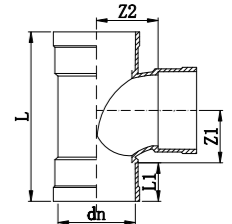

Size (mm)	L (mm)	L1 (mm)	Z1 (mm)	Z2 (mm)
32	90.5	25	20.2	20.2
40	99.5	25	24.7	24.7
50	110	25	33.5	36.7
75	166	40	48.5	55
90	194	45	64.5	70
110	225.6	48.5	76.8	85.5
160	294.5	58.5	99.6	109
200	355	68.5	122.3	135.2
250	439	78.5	155.7	158.3
315	583	110.5	198	203

**90° Elbow**

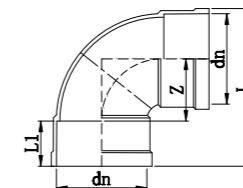

Size (mm)	L (mm)	L1 (mm)	Z (mm)
32	65	25	21.2
40	74	25	26.4
50	88	25	34.7
75	133.8	40	52
90	160	45	65.2
110	182.9	48.5	74
160	246	58.5	101.5
200	301	68.5	125.5
250	361.5	78.5	151
315	463	110.5	185

**45° Elbow**

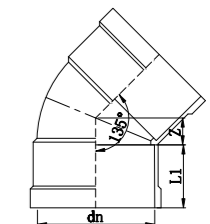

Size (mm)	L1 (mm)	Z (mm)
32	25	8.5
40	25	10.5
50	25	12.3
75	40	17.2
90	45	21.5
110	48.5	25.5
160	58.5	34.6
200	68.5	42.9
250	78.5	55.5
315	110.5	73.2

**PVC-U Drainage Pipe**  
Length : 4 - 6 meter

O.D. (mm)	Thickness (mm)	Pcs (Bundle/Box)
32	2	10x60
40	2	10x40
50	2	5x50
75	2.3	125
90	3	84
110	3.2	60
160	4	30
200	4.9	

**PVC-U Drainage Pipe**  
Length : 4 - 6 meter

O.D. (mm)	Thickness (mm)	Pcs (Bundle/Box)
250	6.2	
315	7.8	
355	8.7	
400	9.8	
450	11	
500	12.3	
630	15.4	

**PVC-U Spiral-Wall DE Noise Pipe**  
Length : 4 - 6 meter

O.D. (mm)	Thickness (mm)	Pcs (Bundle/Box)
75	2.3	125
110	3.2	60
160	4	30

**PVC-U Hollow Spiral Silencing Pipe**  
Length : 4 - 6 meter

O.D. (mm)	Thickness (mm)	Pcs (Bundle/Box)
75	4	123
75	5	123
110	4.6	60
110	6	60
160	5.3	30
160	7	30

**PVC-U Drainage Pipe For High Pressure**  
Length : 4 - 6 meter

O.D. (mm)	Thickness (mm)	Pcs (Bundle/Box)
110	4	60
160	5	30
200	6	
250	8	

### Reducing Sanitary Tee

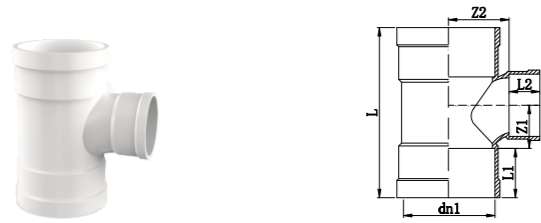

Size (mm)	L (mm)	L1 (mm)	L2 (mm)	Z1 (mm)	Z2 (mm)
40x32	95.6	25	25	22.3	26.4
50x40	104	25	25	27	31.9
75x50	140	40	25	33.5	51.7
90x75	179	45	40	56.8	70.3
110x50	162	48.5	25	38.5	70.9
110x75	186	48.5	40	51	72.6
110x90	200.5	48.5	45	64.3	80
160x110	243.5	58.5	48.5	70.7	103.2
200x110	264.5	68.5	48.5	76	134
200x160	319	68.5	58.5	103	136

### Reducing Sanitary Tee

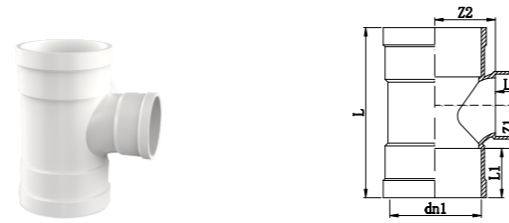

Size (mm)	L (mm)	L1 (mm)	L2 (mm)	Z1 (mm)	Z2 (mm)
250x110	314	78.5	48.5	93.2	152
250x160	364	78.5	58.5	118.5	154.5
250x200	374	78.5	68.5	120.3	156.5
315x110	349	110.5	48.5	74.1	186.5
315x160	404	110.5	58.5	102	188.5
315x200	447	110.5	68.5	124	194.5
315x250	517.5	110.5	85	165	205.4

### Wye

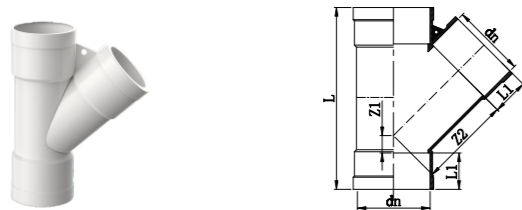

Size (mm)	L (mm)	L1 (mm)	Z1 (mm)	Z2 (mm)
32	102	25	10.3	42.3
40	114.2	25	11.2	54.9
50	122	25	10.5	61.5
75	193	40	18.5	94.5
90	224.5	45	21.3	113.2
110	258.5	48.5	26.5	135
160	349	58.5	36	196
200	429	68.5	44	248
250	519	78.5	55	307

### Reducing Wye

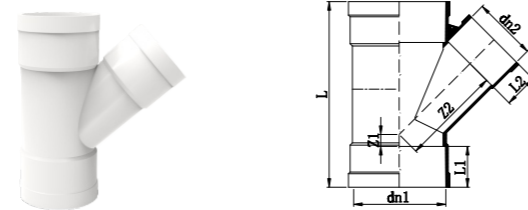

Size (mm)	L (mm)	L1 (mm)	L2 (mm)	Z1 (mm)	Z2 (mm)
40x32	101.5	25	25	5.4	49.9
50x40	115	25	25	6.3	60.3
75x50	155	40	25	1	83
110x32	148	48.5	25	-29.6	97.9
110x50	174	48.5	25	-16.2	109.3
110x75	208	48.5	40	1.5	119
160x110	273.5	58.5	48.5	-2.5	171.4
200x110	309	68.5	48.5	-14.5	203.5
200x160	377	68.5	58.5	18	230.2
250x200	473	85	68.5	24.3	284.5

### Simple Expansion Joint

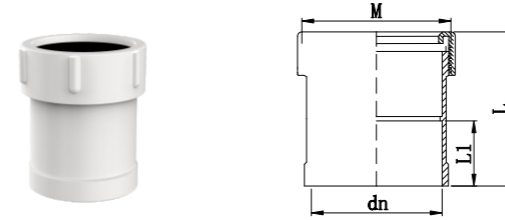

Size (mm)	L (mm)	L1 (mm)	M (mm)
50	73.5	25	M57.8x2
75	101.5	40	Tr87x4
110	122	48.5	Tr124x4
160	138.5	58.5	Tr175.8x4
200	160	68.5	Tr217.8x4

### Expansion Joint



Size (mm)	L (mm)	L1 (mm)	D (mm)
50	67.3	25	74.8
75	106	40	102.5
90	118.6	45	118.6
110	131	48.5	146
160	154	58.5	199.5
200	180	68.5	246

### Thread Expansion Joint

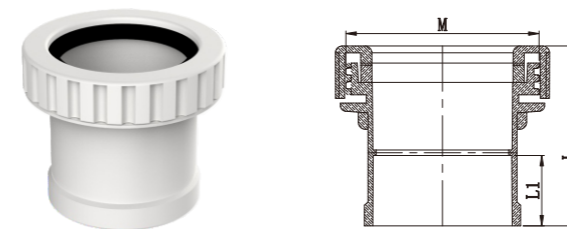

Size (mm)	L (mm)	L1 (mm)	M (mm)
50	65	25	Tr69.5x5
75	94	41	Tr99.4x6
110	119	48.5	Tr134.7x6
160	142	58.5	Tr191.4x6

### Combined Flexible Coupler

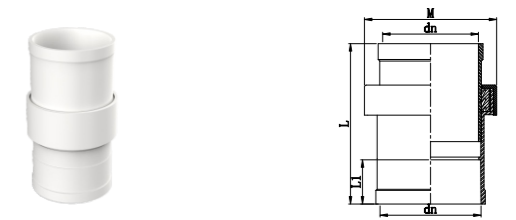

Size (mm)	L (mm)	L1 (mm)	M (mm)
50	103	25	61.6
75	148	40	88
110	176	48.5	125
160	211	58.5	182
200	252	68.5	221

### Reducer

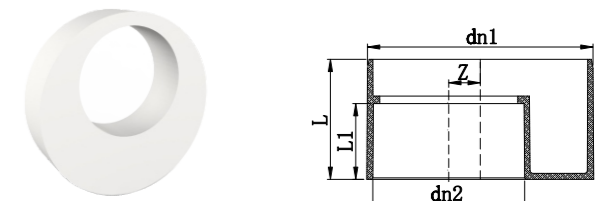

Size (mm)	L (mm)	L1 (mm)	Z (mm)
40x32	23	20	1.5
50x40	25	23	3.4
75x50	40	25	10.5
90x75	45	40	4.4
110x50	48.5	25	27.3
110x75	48.5	40	14.8
110x90	48.5	45	6.5
160x110	57	48.5	21.5
200x110	67.5	48.5	40.1
200x160	67.5	58.5	15
250x200	85	68.5	19
315x250	110	85.5	25.5

Reducing Double Wye

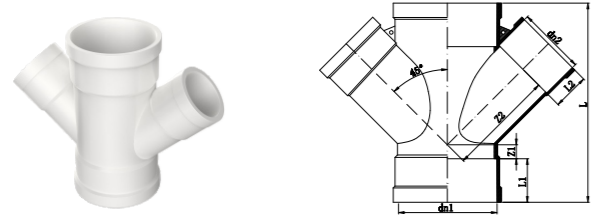

Size (mm)	L (mm)	L1 (mm)	L2 (mm)	Z1 (mm)	Z2 (mm)
50×32	109	25	25	4	53.2
75×50	159	40	25	2.3	86
110×32	148	48.5	25	-29.6	97.9
110×50	174.4	48.5	25	-15.1	108.9
110×75	207	48.5	40	-1	119.6
160×110	284.5	58.5	48.5	3.5	176

Double Wye

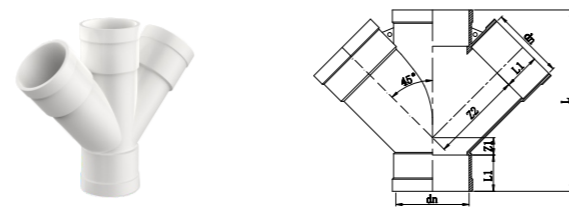

Size (mm)	L (mm)	L1 (mm)	Z1 (mm)	Z2 (mm)
32	105	25	10.4	44.6
40	117	25	13.2	52.8
50	123	25	11	62
75	193	40	18.7	94.3
110	260.5	48.5	26.6	136.9
160	350	58.5	37.5	198.5

Double Sanitary Tee

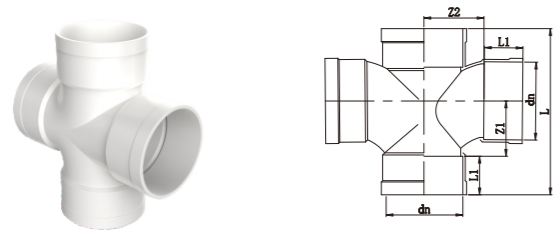

Size (mm)	L (mm)	L1 (mm)	Z1 (mm)	Z2 (mm)
50	107.6	25	28.8	35.2
75	166.3	40	43	52.9
90	217.5	60		
110	223	48.5	75.5	85.5
160	310	58.5	111.2	121.5
200	358.5	68.5	119.2	138.2

Reducing Double Sanitary Tee

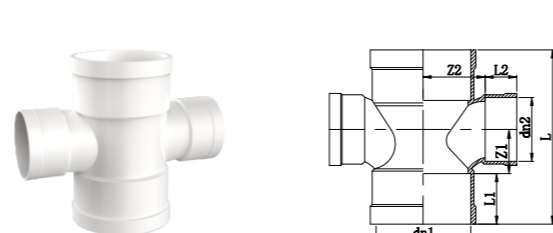

Size (mm)	L (mm)	L1 (mm)	L2 (mm)	Z1 (mm)	Z2 (mm)
75×50	139	40	25	32.7	52
110×50	159	48.5	25	36.9	67.9
110×75	189	48.5	40	53.4	69.9
160×110	244	58.5	48.5	71.5	103.2

45° Elbow with Cleanout

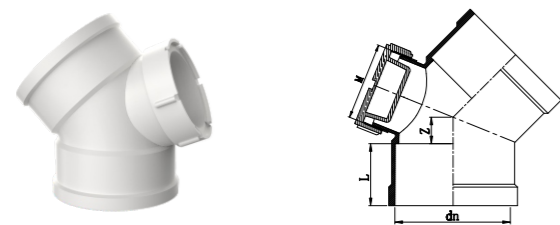

Size (mm)	L (mm)	Z (mm)	M (mm)
110	48.5	25.5	Tr88.8x3
160	58.5	34.6	Tr88.8x3

Sanitary Tee with Cleanout

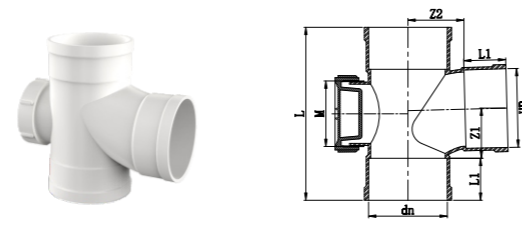

Size (mm)	L (mm)	L1 (mm)	Z1 (mm)	Z2 (mm)	M (mm)
110	226	48.5	73.5	77.5	Tr88.9x3
160	299	58.5	95.5	104.3	Tr88.9x3

Tee with Side Inlet

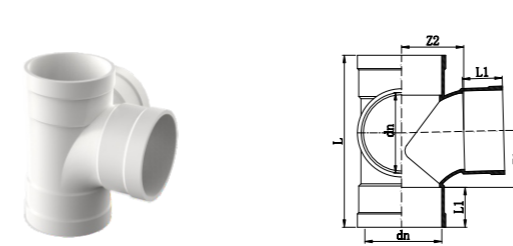

Size (mm)	L (mm)	L1 (mm)	Z1 (mm)	Z2 (mm)
50	106.5	25	30	35
75	181.3	40	66	64
110	219.6	48.5	69.5	80.3
160	309.5	58.5	114.5	125

Reducing Tee with Side inlet

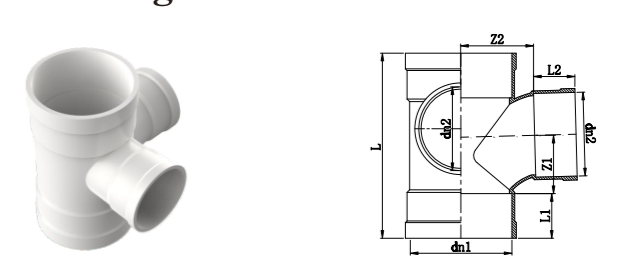

Size (mm)	L (mm)	L1 (mm)	L2 (mm)	Z1 (mm)	Z2 (mm)
75×50	144.5	40	25	41.2	60
110×50	169	48.5	25	43.5	71
110×75	186	48.5	40	50.9	64.3
160×110	254.5	58.5	48.5	81.4	111.5

88° Elbow



Size (mm)	L (mm)	L1 (mm)	Z1 (mm)
75	158	40	76.5
110	216	48.5	107.3
160	324	78.5	179.5

Vent

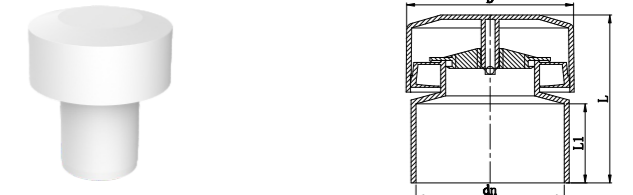

Size (mm)	L (mm)	L1 (mm)	D (mm)
50			
75	108	71	118.7
110	120	53	139.5

90° Elbow with Cleanout

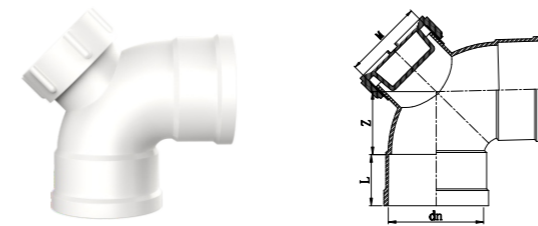

Size (mm)	L (mm)	Z (mm)	M (mm)
50	25	34.7	M44.7x2
75	40	52	Tr63x3
90	45	65.2	Tr63x3
110	48.5	74	Tr88.8x3
160	58.5	101.5	Tr111.2x3
200	68.5	125.5	Tr141.5x4
250	78	151.5	Tr141.5x4
315	110.5	185.5	Tr141.5x4

H Pipe Fitting

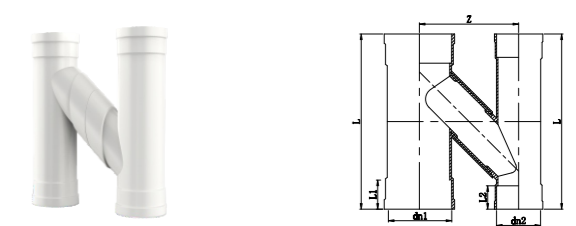

Size (mm)	L (mm)	L1 (mm)	L2 (mm)	Z (mm)
75×75×75	299.5	40	40	180
110×75×75	299.5	48.5	40	180
110×75×110	299.5	48.5	48.5	180
110×110×110	328.5	48.5	48.5	180
160×75×75	299.5	58.5	40	205
160×75×110	299.5	58.5	48.5	205
160×75×160	299.5	58.5	58.5	230

Cleanout Tee

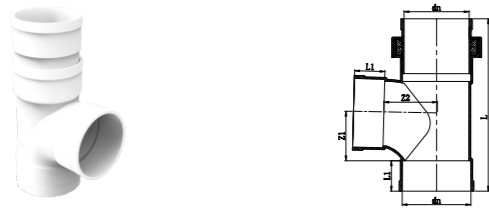

Size (mm)	L (mm)	L1 (mm)	Z1 (mm)	Z2 (mm)
50	159.5	25	33.5	36.7
75	234	40	48.5	55
90				
110	306	48.5	76.8	85.5
160	388	58.5	99.6	109
200				

Eccentric Reducer

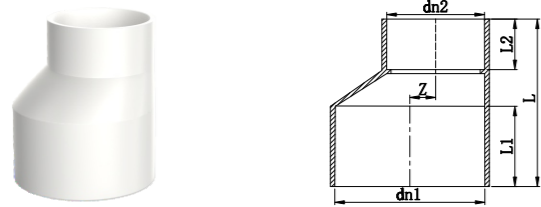

Size (mm)	L (mm)	L1 (mm)	Z1 (mm)	Z (mm)
75x50	84.2	40	25	9.3
110x50	126	48.5	25	26.5
110x75	119.5	48.5	40	19
160x110	149	55	47	21
200x160	168.3	67	58.5	15.5

Bottle Tee

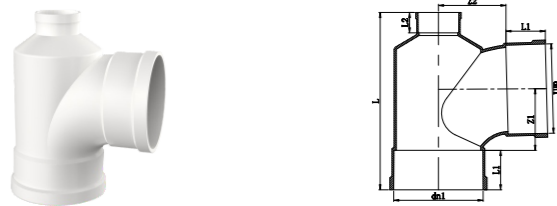

Size (mm)	L (mm)	L1 (mm)	L2 (mm)	Z1 (mm)	Z2 (mm)
110x50	219.5	48.5	25	77	85.5
110x75	225.5	48.5	40	77	85.5

Riser Telescopic Sleeve with cleanout



Size (mm)	L (mm)	L1 (mm)	Z1 (mm)	M (mm)
50	149.5	25	25	M44.7x2
75	220	40	35.9	Tr63x3
90				
110	274.6	48.5	48.3	Tr88.8x3
160	329	58.5	59.2	Tr111.2x3
200				

Reducer

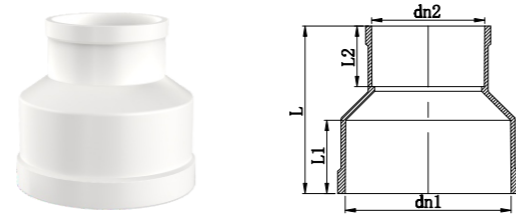

Size (mm)	L (mm)	L1 (mm)	L2 (mm)
75x50	77	40	25
110x50	106	48.5	25
110x75	112	48.5	40
110x90	109	48.5	45
160x110	136	58.5	48.5

Vent Cap(Small)

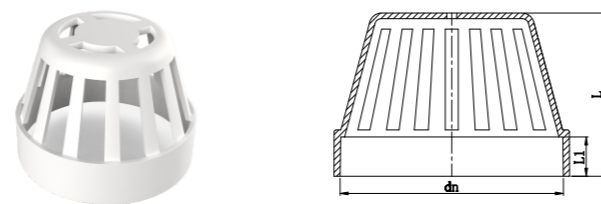

Size (mm)	L (mm)	L1 (mm)
75	60	17
110	81	21
160	99.5	19

Vent Cap(large)

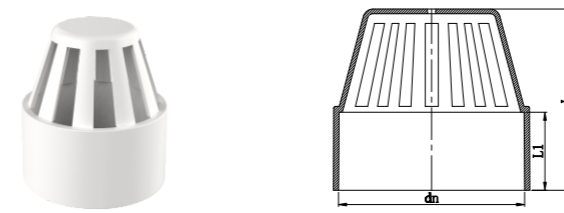

Size (mm)	L (mm)	L1 (mm)
50	60.5	25
75	84	40
110	108	48.5
160	129.5	51.5
200	149	55.5

Cleanout

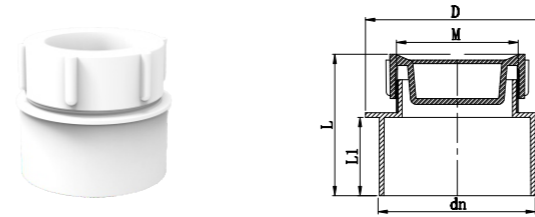

Size (mm)	L (mm)	L1 (mm)	D (mm)	M (mm)
50	52	25	54	44.7x2
75	67.5	36.5	81	Tr63x3
110	82.5	48.5	118.5	Tr88.8x3
160	99.5	57	170.3	Tr141.5x4

Cleanout Tee with Plug



Size (mm)	L (mm)	L1 (mm)	Z1 (mm)	M (mm)
50	100	25	25	M44.7x2
75	151.8	40	35.9	Tr63x3
90	192.6	45	51.3	Tr88.8x3
110	193.6	48.5	48.3	Tr88.8x3
160	235.4	58.5	59.2	Tr111.2x3
200	315	68.5	89	Tr141.5x4

Round Floor Sink

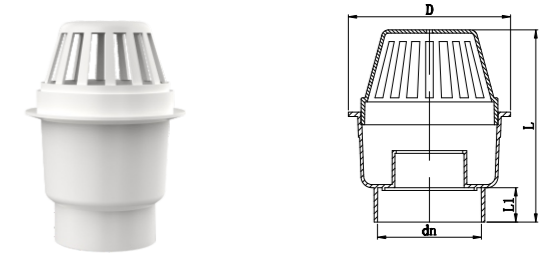

Size (mm)	L (mm)	L1 (mm)	D (mm)
50	142	25	106.5
75	185	37	142
110	139	48.5	143
110(Large)	234	48.5	193
160	283	58.5	238

Floor Cleanout

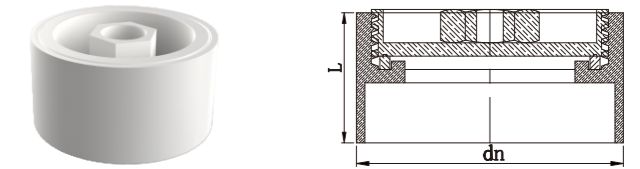

Size (mm)	L (mm)
50	25.5
75	40
90	45
110	48.5
160	58

Leakproof Ring

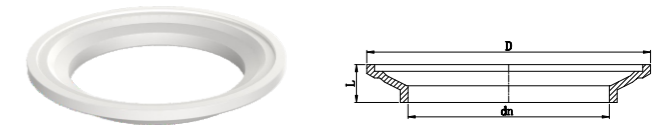

Size (mm)	L (mm)	D (mm)
50	14	78
75	17	110
90	17	126.5
110	18	148.3
160	20	204

**Cleanout(Extrapolation)**

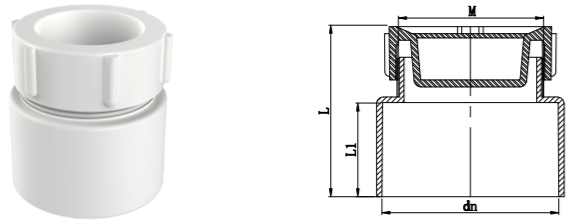

Size (mm)	L (mm)	L1 (mm)	M (mm)
50	56	26.5	M44.7x2
75	70	40	Tr63x3
90	77	45	Tr88.8x3
110	83	48.5	Tr88.8x3
160	96.5	55	Tr111.2x3
200	107	65	Tr141.5x4
250			
315			

**WC Adaptor**

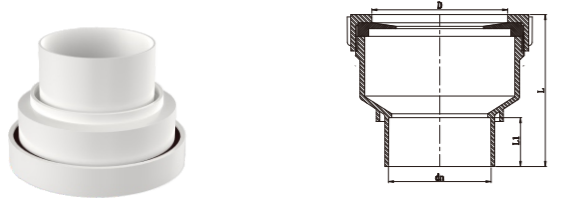

Size (mm)	L (mm)	L1 (mm)	D (mm)
90			
110	108	53	127.8

**WC Elbow Adaptor**

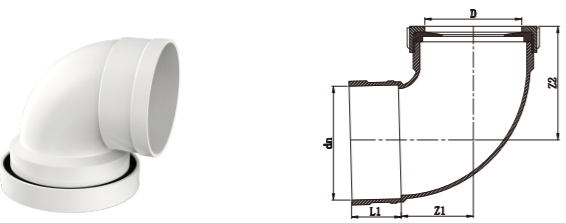

Size (mm)	L1 (mm)	D (mm)	Z1 (mm)	Z2 (mm)
110	48.5	127.8	55.5	107.2

**Floor Drain**

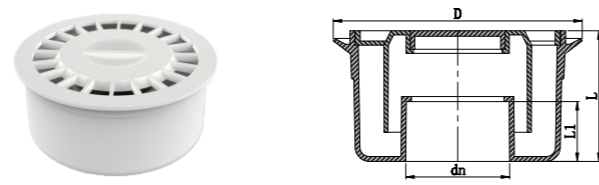

Size (mm)	L (mm)	L1 (mm)	D (mm)
50	54	25	114
75	75.4	40	151
110	98	48.5	195.5

**Simple Floor Drain (Extrapolation)**

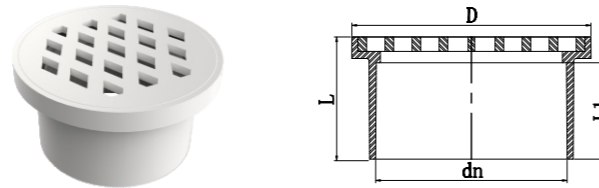

Size (mm)	L (mm)	L1 (mm)	D (mm)
50	39	31.5	71.4
75	48.3	39.8	94.3
110	53	44.5	117.2
160	93.5	60	193.5

**Simple Floor Drain (Interpolation)**

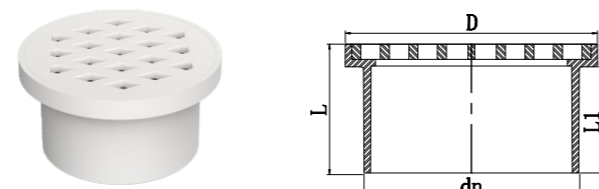

Size (mm)	L (mm)	L1 (mm)	D (mm)
50	35	30	61
75	50	45	84
110	53	44	117
160	80	67	174

**T-type Floor Drain**

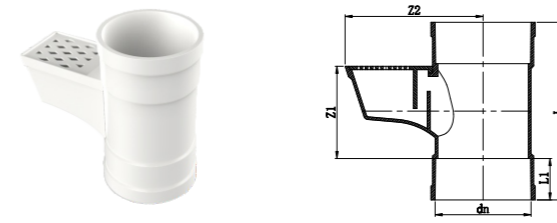

Size (mm)	L (mm)	L1 (mm)	Z1 (mm)	Z2 (mm)
75	144	38	66	110.5
110	205	48.5	106.5	160

**Multi Function Floor Seal Drain**

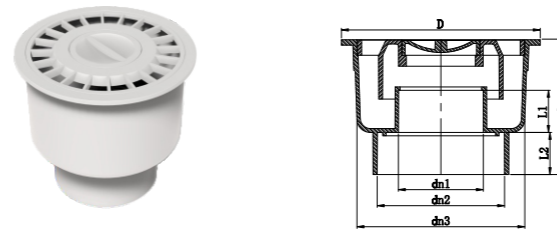

Size (mm)	L (mm)	D (mm)	L1 (mm)	L2 (mm)
40/50/75	65	78	18	25
50/75/110	80	114	25	25
50/75/90/110	82	114	25	25

**Circular Floor Drain Sealed**



Size (mm)
50
75
110

**Long Multi Function Floor Drain**

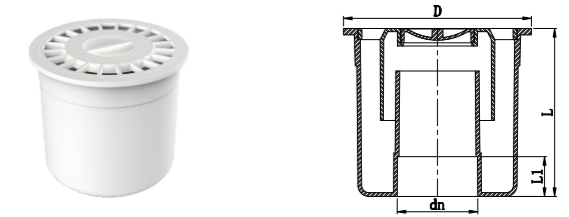

Size (mm)	L (mm)	L1 (mm)	D (mm)
50/110	105.5	25	118
75/110	110	33	118

**Side Floor Drain**



Size (mm)	L (mm)	L1 (mm)	A (mm)	B (mm)
40				
50	70	25	93	63
75	107.5	40	138	98
110	118	48.5	153	128

**Square Floor Seal Drain**



Size (mm)
50
75
110

**Multi Function Floor Drain**

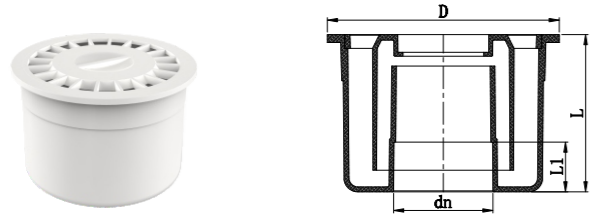

Size (mm)	L (mm)	L1 (mm)	D (mm)
50/110	80	25	118

**Reducing Tee with Down Interpolation**

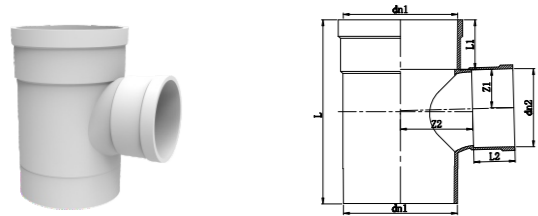

Size (mm)	L (mm)	L1 (mm)	L2 (mm)	Z1 (mm)	Z2 (mm)
110×110×75	178	48.5	40	36.2	69.4

**Reducing Tee with Upward Interpolation**

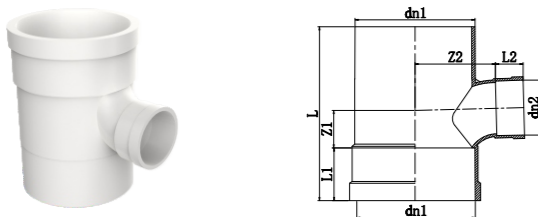

Size (mm)	L (mm)	L1 (mm)	L2 (mm)	Z1 (mm)	Z2 (mm)
110×110×50	205	48.5	25	37	75

**90° Elbow Interpolation**



Size (mm)	L1 (mm)	Z1 (mm)	Z2 (mm)
50	25	25.8	64.5

**Floor Drain for Wash Machine**

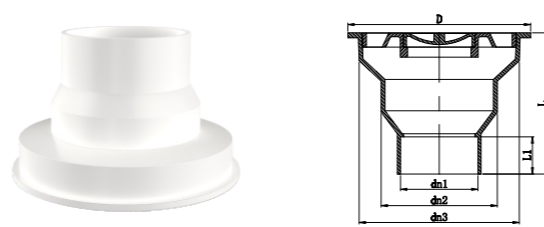

Size (mm)	L (mm)	L1 (mm)	D (mm)
50/75/110	73.3	25	113.8

**Equal Tee with Down Interpolation**

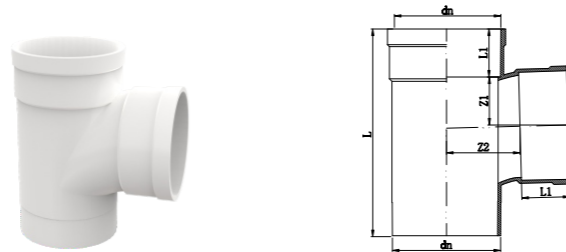

Size (mm)	L (mm)	L1 (mm)	Z1 (mm)	Z2 (mm)
110×110×110	211	48.5	50.7	75.5

**Multi-Function Pre-Buried Coupling**

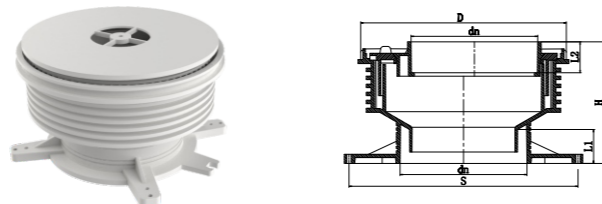

Size (mm)	H (mm)	L1 (mm)	L2 (mm)	S (mm)	D (mm)
110	106	30	27	200	180

**Pre-Buried Drain**

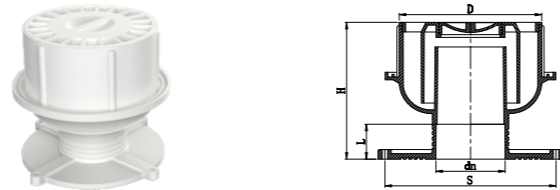

Size (mm)	H (mm)	L (mm)	S (mm)	D (mm)
50	110	25	125	103.5

**U-Trap**

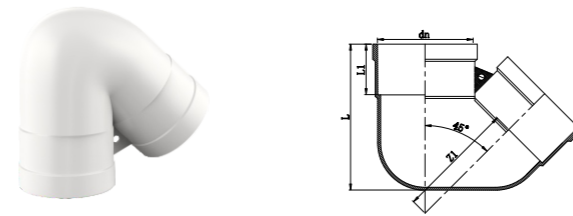

Size (mm)	L (mm)	L1 (mm)	Z1 (mm)
40	82	25	77
50	87	25	66
75	115.7	40	94.3
90	139	45	113
110	159.7	48.5	134.7
160	220.2	58.5	197.3

**U-Trap with Cleanout**

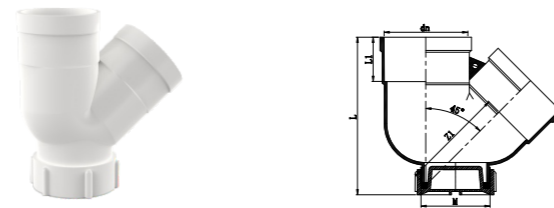

Size (mm)	L (mm)	L1 (mm)	Z1 (mm)	M (mm)
40	103	25	77	M44.7x2
50	109	25	66	M44.7x2
75	142	40	94.3	Tr63x3
90	167	45	113	Tr63x3
110	180	48.5	134.7	Tr88.8x3
160	252.3	58.5	197.3	Tr111.2x3

**S-Trap**

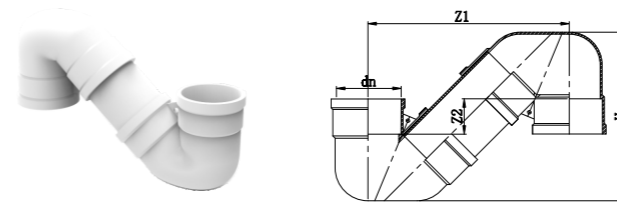

Size (mm)	H (mm)	Z1 (mm)	Z2 (mm)
40	159	147	55
50	160	168	56
75	188	225	55

**P-Trap**

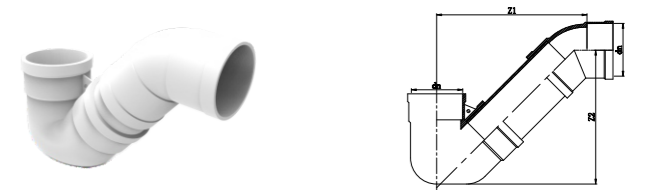

Size (mm)	Z1 (mm)	Z2 (mm)
40	129	124
50	142	126
75	188	152
90	226	186
110	270	221
160	359	288

**P-Trap with cleanout**

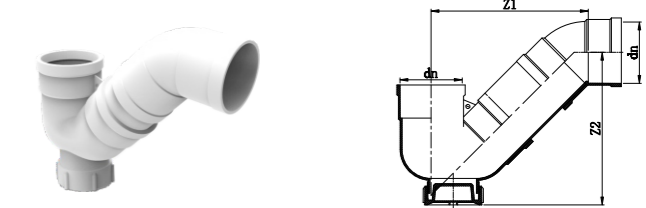

Size (mm)	Z1 (mm)	Z2 (mm)
40	129	124
50	142	126
75	188	152
90	226	186
110	270	221
160	359	288

**S-Trap**

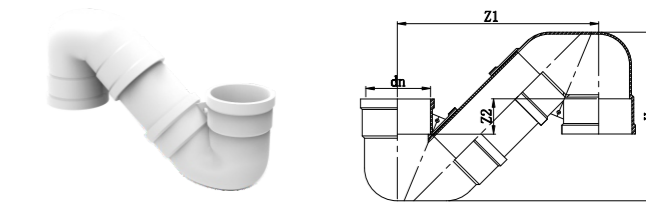

Size (mm)	H (mm)	Z1 (mm)	Z2 (mm)
90	232	270	55
110	276	322	60
160	368	440	55

**S-Trap with Single Door**

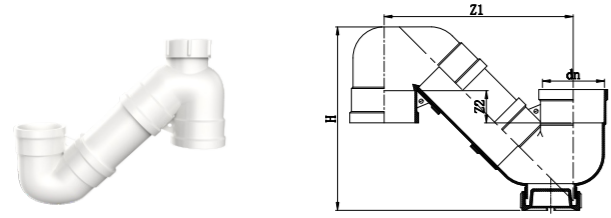

Size (mm)	H (mm)	Z1 (mm)	Z2 (mm)
40	180	147	55
50	182	168	56
75	214	225	55
90	261	270	55
110	296	322	60
160	395	440	55

**S-Trap with Double Door**

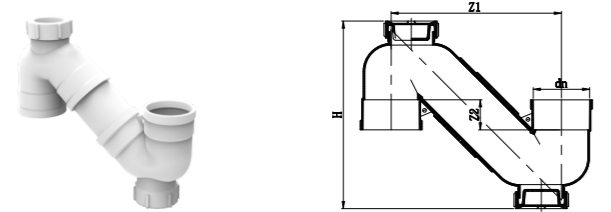

Size (mm)	H (mm)	Z1 (mm)	Z2 (mm)
40	159	147	55
50	160	168	56
75	188	225	55
90	232	270	55
110	276	322	60
160	368	440	55

**S-Trap with Cleanout**

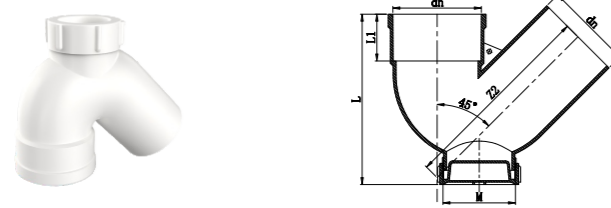

Size (mm)	L (mm)	L1 (mm)	Z2 (mm)	M (mm)
50	99	25	105	M44.7x2
75	145	40	150	Tr63x3
110	183	48.5	233	Tr88.8x3

**Pipe Clamp (without Screw)**

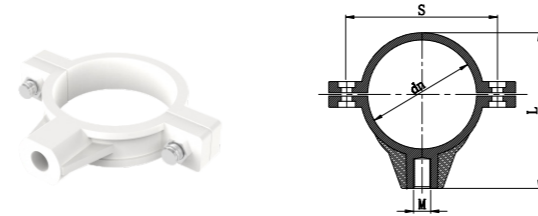

Size (mm)	L (mm)	S (mm)	M (mm)
50	72.5	70	M10
75	99	100	M10
90	120	118	M10
110	136.5	141	M10
160	192.5	189	M10
200	235	228	M12

**Pipe Clamp (Screw)**



Size (mm)	L (mm)	L1 (mm)	S (mm)
50	127	72.5	70
75	154	99	100
90	175	120	118
110	191	136.5	141
160	247	192.5	189
200	330	235	228

**Cap**

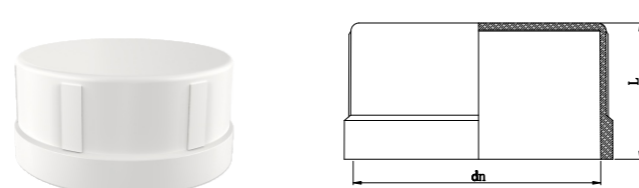

Size (mm)	L (mm)
50	27
75	42
110	51.5
160	78

**Silencing Sanitary Tee**



Size (mm)	L (mm)	L1 (mm)	Z1 (mm)	Z2 (mm)	Z3 (mm)
110×110×110	419.5	48.5	259	63.5	141.3

**Silencing Sanitary Flexible Tee**

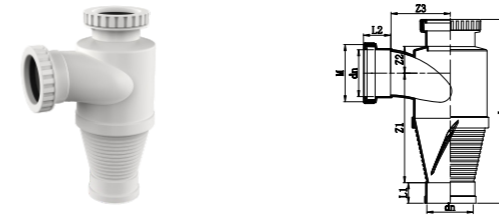

Size (mm)	L (mm)	L1 (mm)	L2 (mm)	Z1 (mm)	Z2 (mm)	Z3 (mm)	M (mm)
110×110×110	434	48.5	63	259	63.5	141.3	Tr134.7x6

**Silencing Sanitary Reducing Cross(Right)**

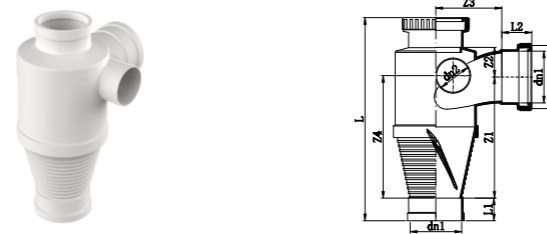

Size (mm)	L (mm)	L1 (mm)	Z1 (mm)	Z2 (mm)	Z3 (mm)	Z4 (mm)
110×110×110×75	419.5	48.5	259	63.5	141.3	262

**Silencing Sanitary Reducing Flexible Cross(Right)**

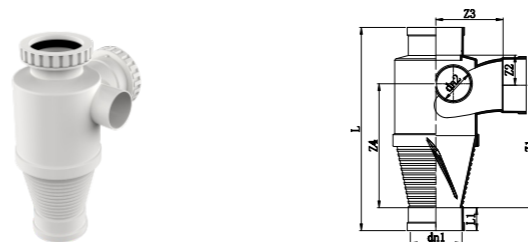

Size (mm)	L (mm)	L1 (mm)	L2 (mm)	Z1 (mm)	Z2 (mm)	Z3 (mm)	Z4 (mm)	M (mm)
110×110×110×75	434	48.5	63	259	63.5	141.3	262	Tr134.7x6



**Silencing Sanitary Reducing Cross(Left)**

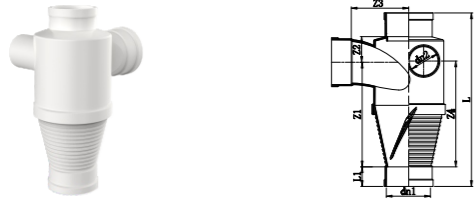

Size (mm)	L (mm)	L1 (mm)	Z1 (mm)	Z2 (mm)	Z3 (mm)	Z4 (mm)
110×110 ×110×75	419.5	48.5	259	63.5	141.3	262

**Silencing Sanitary Reducing Flexible Cross(Left)**

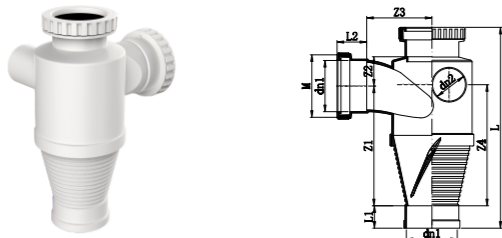

Size (mm)	L (mm)	L1 (mm)	L2 (mm)	Z1 (mm)	Z2 (mm)	Z3 (mm)	Z4 (mm)	M (mm)
110×110 ×110×75	434	48.5	63	259	63.5	141.3	262	Tr134.7x6

**Silencing Combined Connect with Cleanout**



Size (mm)	L (mm)	L1 (mm)	Z (mm)	M1 (mm)	M2 (mm)
110	243	63.8	86.5	Tr134.7x6	Tr88.8x3

**Spiral-wall Silencing Tee**



Size (mm)	L (mm)	L1 (mm)	L2 (mm)	Z1 (mm)	Z2 (mm)	M (mm)
75	212	53.5	72.5	70.5	126	Tr99.4x6
110	264	75	90	70	165	Tr134.7x6

**Silencing 45° Elbow**



Size (mm)	L (mm)	L1 (mm)	Z1 (mm)	M (mm)
110	204	65.7	25.4	Tr134.7x6

**Silencing 90° Elbow**

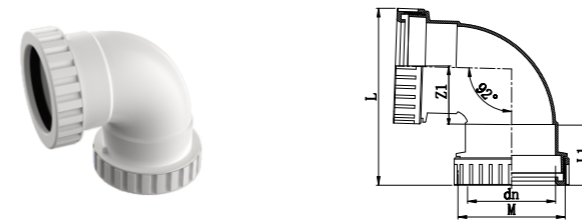

Size (mm)	L (mm)	L1 (mm)	Z1 (mm)	M (mm)
110	211	65.5	73.5	Tr134.7x6

**S Pipe Fitting**



Size (mm)
75
90
110
160
200

**Strengthen Eccentric Reducer**

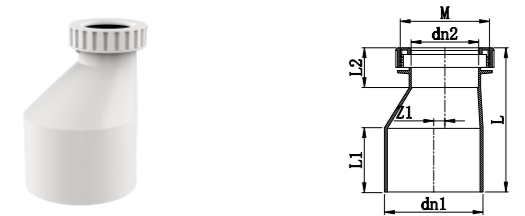

Size (mm)	L (mm)	L1 (mm)	L2 (mm)	Z1 (mm)	M (mm)
110×50	162	71	38.5	25.5	Tr69.5x6
110×75	160	71	43.5	12.5	Tr99.4x6

**Silencing 90° Elbow with Cleanout**

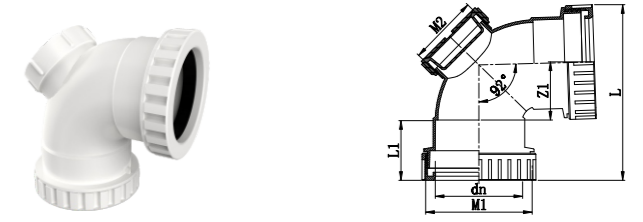

Size (mm)	L (mm)	L1 (mm)	Z1 (mm)	M1 (mm)	M2 (mm)
110	211	65.5	73.5	Tr134.7x6	Tr88.8x3

# Indicators of PVC-U Pipe

## Color

The colour is usually white, however we are able to customize other colours upon request.

## Appearance

The inner and outer walls of the pipe will be smooth with no bubbles, cracks & obvious marks, depressions, uneven colours and colour lines of decomposition. The fittings will be complete and free from defects. The gate and overflow will be repaired with smooth surface, no obvious mark, variegated or cold spot.

## Mechanical Properties

	Pipe	Fittings
Density(kg/m <sup>3</sup> )	1350-1550	1350-1550
Vical softening Temperature (°C)	≥ 79	≥ 74
Longitudinal Reversion Rate (%)	≤ 5	
Dichloromethane Resistance	Surface changes are not inferior to 4L	
Tensile Yield Strength(MPa)	≥40	
Falling Weight Impact Test (0°C,TIR)	TIR≤10%	
Oven Test	Accord with standard	
Drop Test	No rupture	
Water Tightness Test	Impermeable	
Air Tightness Test	Impermeable	

## Installation of PVC-U Drainage Pipe

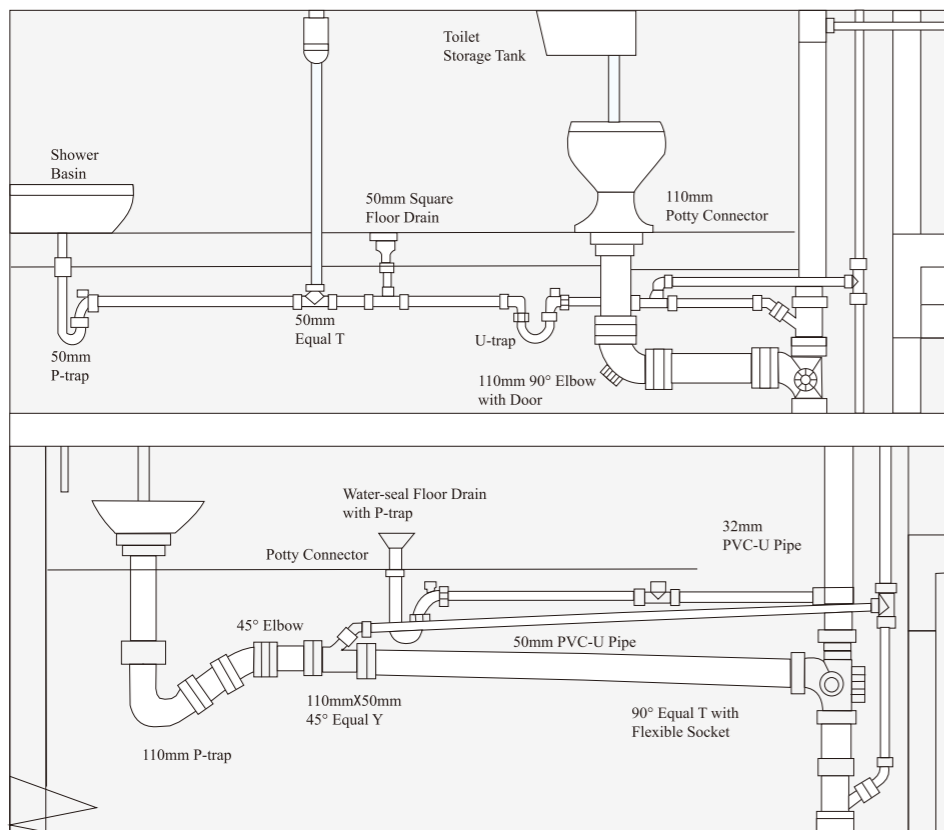

## 01 Flexible Coupler and Pipe Strap installed position

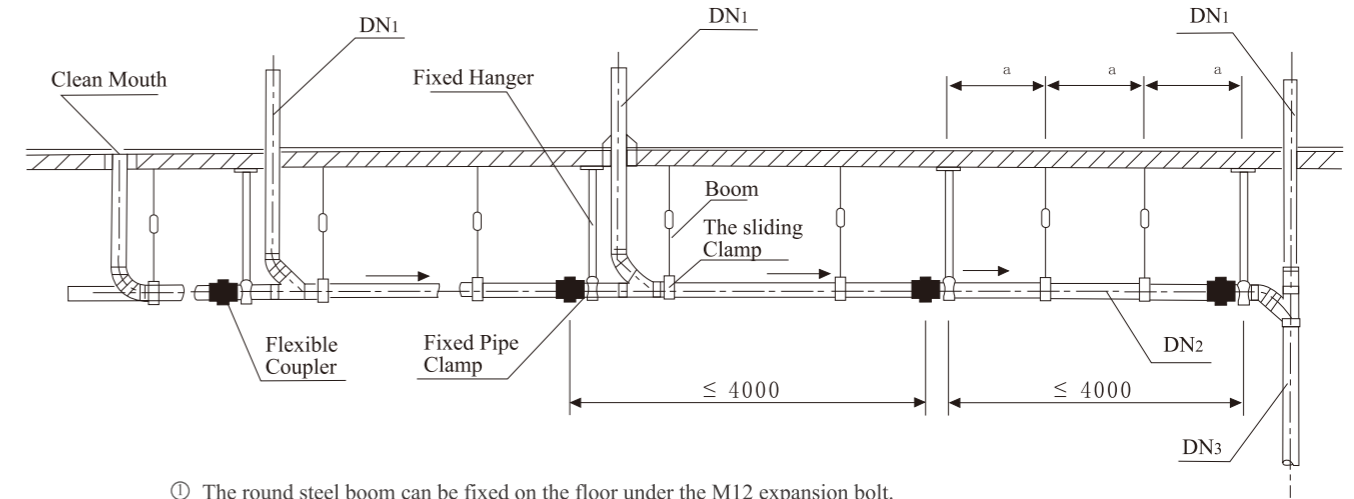

- ① The round steel boom can be fixed on the floor under the M12 expansion bolt.
- ② The pipe connection meets  $DN_1 \leq DN_2 \leq DN_3$ .
- ③ Between two Fixed Pipe Clamps can be set to the Sliding Clamp.

## 02 Installation of Combined Connector For De-Noise

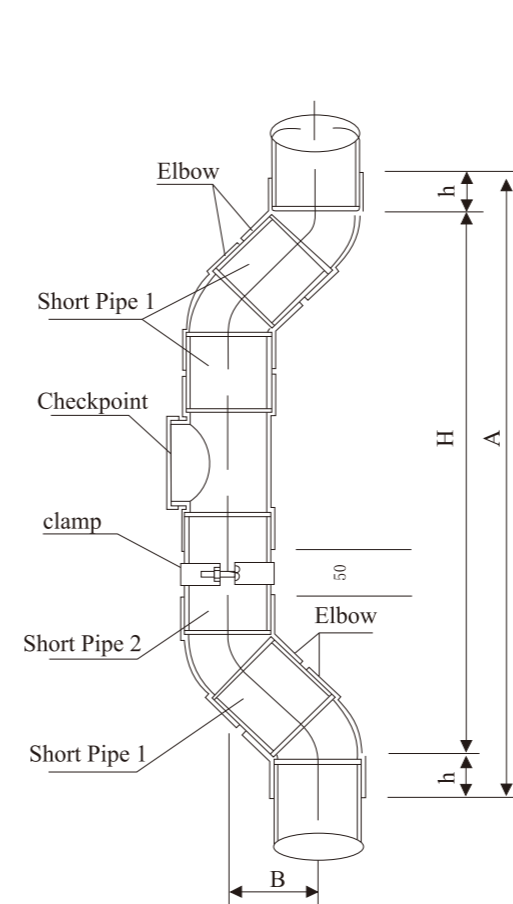

## 03 Installation of High-rise drain pipe and Exhaust Pipe

