

HOMSO 雄塑®

stock code:300599

HOMSO 雄塑®



2018
HOMSO
product catalogue

PVC-U

Water Supply Pipe and Fittings



CONTACT US



WWW.XIONGSU.CN



gdxs@xionsu.cn



0757-86518888

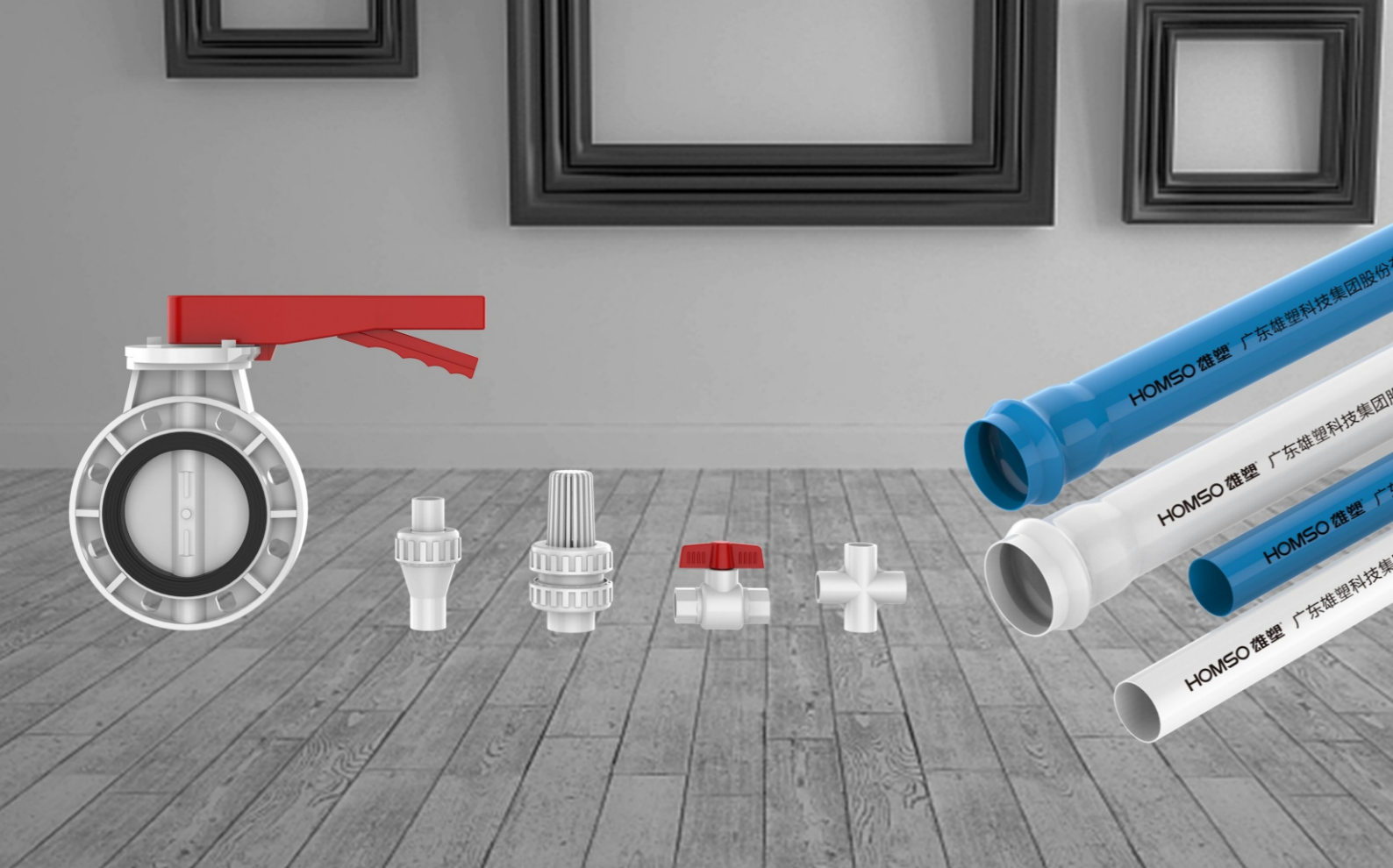

PVC-U Water Supply Pipe
• Working Pressure :0.63Mpa

O.D. (mm)	Thickness (mm)	SDR
63	2	33
75	2.3	33
90	2.8	33
110	2.7	41
125	3.1	41
140	3.5	41
160	4	41
180	4.4	41
200	4.9	41

PVC-U Water Supply Pipe
• Working Pressure :0.8Mpa

O.D. (mm)	Thickness (mm)	SDR
50	2	26
63	2.5	26
75	2.9	26
90	3.5	26
110	3.4	33
125	3.9	33
140	4.3	33
160	4.9	33
180	5.5	33
200	6.2	33

PVC-U Water Supply Pipe
• Working Pressure :1.0Mpa

O.D. (mm)	Thickness (mm)	SDR
40	2	21
50	2.4	21
63	3	21
75	3.6	21
90	4.3	21
110	4.2	26
125	4.8	26
140	5.4	26
160	6.2	26
180	6.9	26
200	7.7	26

PVC-U Water Supply Pipe
• Working Pressure :1.25Mpa

O.D. (mm)	Thickness (mm)	SDR
32	2	17
40	2.4	17
50	3	17
63	3.8	17
75	4.5	17
90	5.4	17
110	5.3	21
125	6	21
140	6.7	21
160	7.7	21
180	8.6	21
200	9.6	21

PVC-U Water Supply Pipe
• Working Pressure :1.6Mpa

O.D. (mm)	Thickness (mm)	SDR
25	2	13.6
32	2.4	13.6
40	3	13.6
50	3.7	13.6
63	4.7	13.6
75	5.6	13.6
90	6.7	13.6
110	6.6	17
125	7.4	17
140	8.3	17
160	9.5	17
180	10.7	17
200	11.9	17

PVC-U Water Supply Pipe
• Working Pressure :2.0Mpa

O.D. (mm)	Thickness (mm)	SDR
20	2	11
25	2.3	11
32	2.9	11
40	3.7	11
50	4.6	11
63	5.8	11
75	6.9	11
90	8.2	11
110	8.1	13.6
125	9.2	13.6
140	10.3	13.6
160	11.8	13.6
180	13.3	13.6
200	14.7	13.6

PVC-U Water Supply Pipe with Socket
• Working Pressure :0.63Mpa

O.D. (mm)	Thickness (mm)	SDR
63	2	33
75	2.3	33
90	2.8	33
110	2.7	41
125	3.1	41
140	3.5	41
160	4	41
180	4.4	41
200	4.9	41
225	5.5	41
250	6.2	41
280	6.9	41
315	7.7	41
355	8.7	41
400	9.8	41
450	11	41
500	12.3	41
630	15.4	41

PVC-U Water Supply Pipe with Socket
• Working Pressure :0.8Mpa

O.D. (mm)	Thickness (mm)	SDR
63	2.5	26
75	2.9	26
90	3.5	26
110	3.4	33
125	3.9	33
140	4.3	33
160	4.9	33
180	5.5	33
200	6.2	33
225	6.9	33
250	7.7	33
280	8.6	33
315	9.7	33
355	10.9	33
400	12.3	33
450	13.8	33

PVC-U Water Supply Pipe with Socket
• Working Pressure :1.0Mpa

O.D. (mm)	Thickness (mm)	SDR
63	3	21
75	3.6	21
90	4.3	21
110	4.2	26
125	4.8	26
140	5.4	26
160	6.2	26
180	6.9	26
200	7.7	26
225	8.6	26
250	9.6	26
280	10.7	26
315	12.1	26
355	13.6	26
400	15.3	26
450	17.2	26

Coupling

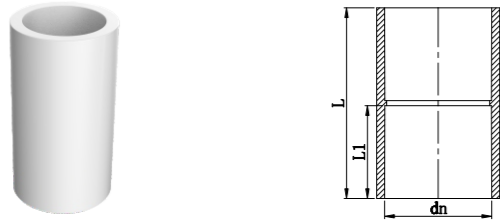

Size (mm)	L (mm)	L1 (mm)
20	47.5	23
25	52	25
32	58	28
40	70	34
50	81	39
63	92.5	45
75	102.5	50
90	122.5	60

Coupling

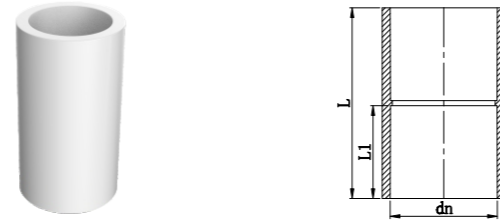

Size (mm)	L (mm)	L1 (mm)
110	129.5	63
125	144	70
140	161	78
160	178	87
180	201	98
200	225	110
225	247	120
250	255	125

90° Elbow

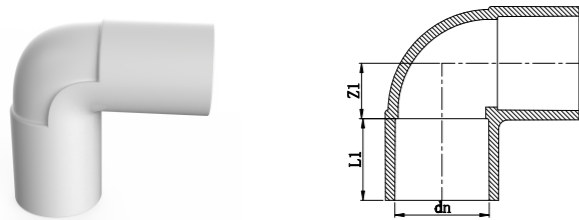

Size (mm)	L1 (mm)	Z1 (mm)
20	23	12.2
25	25	14.7
32	28	19
40	34	23
50	39	28
63	45	35.5
75	50	41.5
90	60	48.8
110	63	59.8
160	87	82.8
200	110	111.5
250	125	134

45° Elbow



Size (mm)	L1 (mm)	Z1 (mm)
20	23	4.7
25	25	5.8
32	28	8.5
40	34	10.8
50	39	12.6
63	45	15.5
75	50	18.8
90	60	23
110	63	26.6
160	87	37.3
200	110	48.3
250	125	79.5

90° Equal Tee



Size (mm)	L (mm)	L1 (mm)	Z1 (mm)	Z2 (mm)
20	70.4	23	12.2	12.2
25	79.4	25	14.7	14.7
32	94	28	19	19
40	114	34	23	23
50	134	39	28	28
63	160.6	45	35.3	35.5

90° Equal Tee

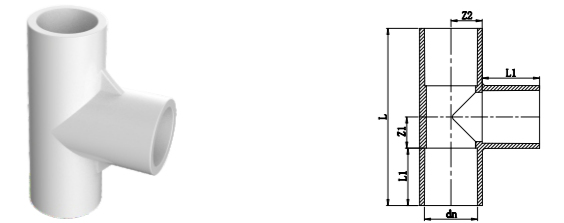

Size (mm)	L (mm)	L1 (mm)	Z1 (mm)	Z2 (mm)
75	182.6	50	41.3	41.3
90	217.6	60	48.8	48.8
110	245.6	63	59.8	59.8
160	335.4	87	80.7	80.7
200	437	110	108.5	108.5
250	514	125	132	132

90° Reducing Tee

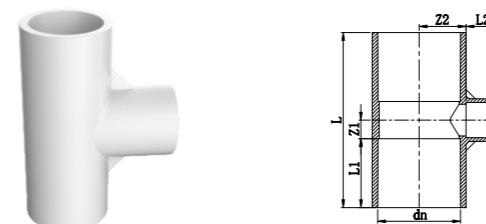

Size (mm)	L (mm)	L1 (mm)	L2 (mm)	Z1 (mm)	Z2 (mm)
25x20	74	25	23	12	14.7
32x20	80	28	23	12	18
32x25	85	28	25	14.5	18
40x20	94	34	23	13	22
40x25	100	34	25	16	22
40x32	107	34	28	19.5	22.8
50x20	105	39	23	13.5	27
50x25	110	39	25	16	27
50x32	117	39	28	19.5	27.8
50x40	124	39	34	23	28
63x25	123	45	25	16.5	33.5
63x32	129	45	28	19.5	34.3
63x40	137	45	34	23.5	34.5
63x50	147	45	39	28.5	34.5
75x32	137	50	28	18.5	42
75x40	144.6	50	34	22.3	40.7

90° Reducing Tee

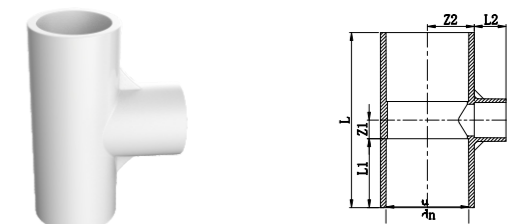

Size (mm)	L (mm)	L1 (mm)	L2 (mm)	Z1 (mm)	Z2 (mm)
75x50	154.6	50	39	27.3	40.7
75x63	167.6	50	45	33.8	41.7
90x40	167.6	60	34	23.8	47.5
90x50	177.6	60	39	28.8	47.5
90x63	190.4	60	45	35.2	48
90x75	202.4	60	50	41.2	48
110x50	185.4	63	39	29.7	57
110x63	198.4	63	45	36.2	57.3
110x75	210.4	63	50	42.2	57.3
110x90	225.4	63	60	49.7	58.3
160x110	287	87	63	56.5	83.3
200x110	338	110	63	59	106
200x160	392	110	87	86	108
250x160	423	125	100	86.5	132
250x200					

90° Reducing Elbow

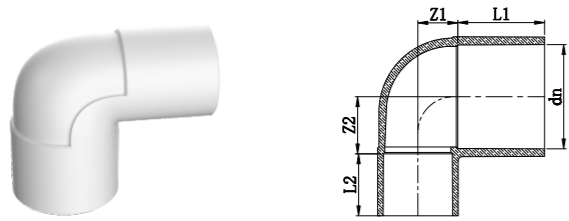

Size (mm)	L1 (mm)	L2 (mm)	Z1 (mm)	Z2 (mm)
25x20	25	23	12	14.5
32x20	28	23	12	18.5
32x25	28	25	14	19
40x20	34	23	11	22
40x25	34	25	14	20.5
40x32	34	28	19	21
50x25	39	25	14.5	29
50x32	39	28	18.5	28.3

90° Reducing Elbow

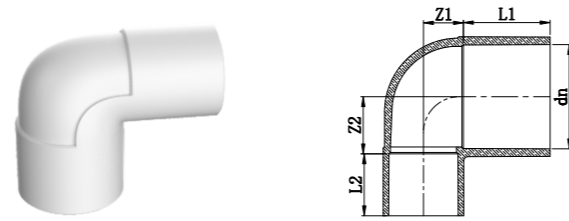

Size (mm)	L1 (mm)	L2 (mm)	Z1 (mm)	Z2 (mm)
50x40	39	34	20.7	26.5
63x32	45	28	24.5	34
63x40	45	34	21.5	35
63x50	45	39	26.5	34.8
75x32	50	28	22.5	41
75x40	50	34	23	41.3
75x50	50	39	28	41.8
75x63	50	45	34	41

Male Thread Elbow

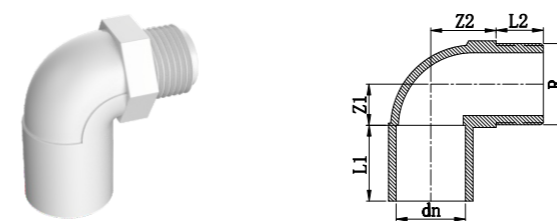

Size (mm)	L1 (mm)	L2 (mm)	Z1 (mm)	Z2 (mm)
20xRc½"	23	16	12	21
25xRc½"	25	16	12	26
25xRc¾"	25	18	15	24
32xRc½"	28	18	12	29
32xRc¾"	28	18	22	28
32xRc1"	28	20	17	27

Male Thread Tee

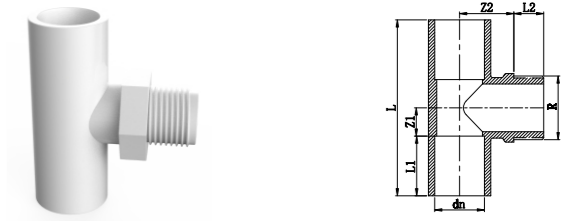

Size (mm)	L (mm)	L1 (mm)	L2 (mm)	Z1 (mm)	Z2 (mm)
20xRc½"	68	23	16	11	27.8
25xRc½"	77.4	25	16	13.7	32.4
25xRc¾"	83	25	18	16.5	32.3
32xRc½"	75	28	16	9.5	33.6
32xRc¾"	93	28	18	18.5	35.6
32xRc1"	85.4	28	18	14.7	35.6

Female Thread Tee

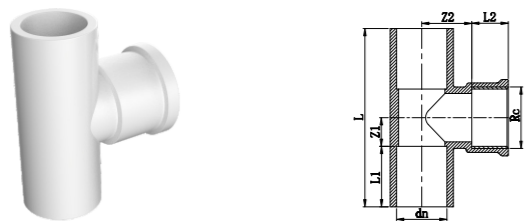

Size (mm)	L (mm)	L1 (mm)	L2 (mm)	Z1 (mm)	Z2 (mm)
20xRc½"	68	23	17	11	20
25xRc½"	73	25	17	11.5	22.5
25xRc¾"	77.4	25	19	13.7	22.5
32xRc½"	79	28	17	11.5	26.5
32xRc¾"	84	28	19	14	26.5
32xRc1"	89	28	21	16.5	27.5

Female Thread Elbow

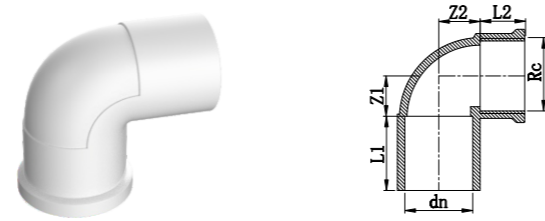

Size (mm)	L1 (mm)	L2 (mm)	Z1 (mm)	Z2 (mm)
20xRc½"	23	17	12.1	16.2
25xRc½"	25	17	12	16.6
25xRc¾"	25	19	15	17.6
32xRc½"	28	17	13	21.5
32xRc¾"	28	19	15	21.5
32xRc1"	28	21	18.5	21.5

Female Tee (Copper Thread)

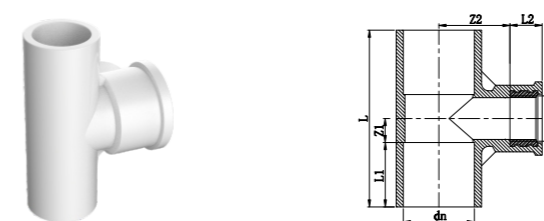

Size (mm)	L (mm)	L1 (mm)	L2 (mm)	Z1 (mm)	Z2 (mm)
20xRc½"	69	23	14.5	11.5	21
25xRc¾"	77.4	25	17	13.7	27.6
25xRc½"	73	25	14.5	11.5	28
32xRc½"	79.6	28	14.5	11.8	32
32xRc¾"	84	28	17	14	31.3
32xRc1"	91	28	19	17.5	32.5
40xRc1¼"					

Female Tee (Copper Thread)

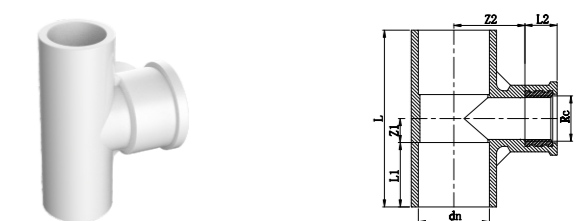

Size (mm)	L (mm)	L1 (mm)	L2 (mm)	Z1 (mm)	Z2 (mm)
40xRc1"	113.8	40	19	16.9	35.9
40xRc¾"	107.6	40	17	13.8	35.9
50xRc1¼"	133	45	22	21.5	41
50xRc1½"	125	39	22	23.5	43.1
50xRc1"	111.6	39	19	16.8	40.9
50xRc¾"	105.4	39	17	13.7	40.2

Female Elbow (Copper Thread)

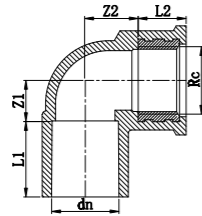

Size (mm)	L1 (mm)	L2 (mm)	Z1 (mm)	Z2 (mm)
20xRc½"	23	14.5	12	17
25xRc¾"	25	17	16.5	18.5
25xRc½"	25	14.5	13	18
32xRc½"	28	14.5	16.5	22.5
32xRc¾"	28	17	16.5	22
32xRc1"	28	19	21	21.5
40xRc1¼"	34	22	27	29
40xRc1"	40	19	23.5	28.4
40xRc¾"	40	17	17	28.4

Female Elbow (Copper Thread)

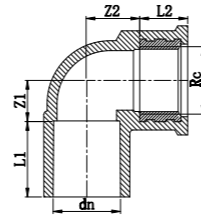

Size (mm)	L1 (mm)	L2 (mm)	Z1 (mm)	Z2 (mm)
50xRc1¼"	45	22	26	35
50xRc1½"	39	22	28	35
50xRc1"	39	19	21.5	33.7
50xRc¾"	39	17	17.3	33.3
63xRc1"	55	19	21	44.5
63xRc1¼"	55	22	27	43.3
63xRc1½"	55	22	29	43.5
63xRc2"	45	27	36	42

Female Coupling (Copper Thread)

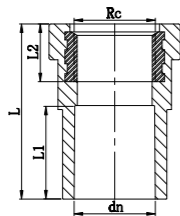

Size (mm)	L (mm)	L2 (mm)	L2 (mm)
20xRc½"	44	23	14.5
25xRc¾"	45.5	25	17
25xRc½"	45	25	14.5
32xRc½"	54	28	14.5
32xRc¾"	55	28	17
32xRc1"	54	28	19
40xRc1"	69.5	34	19

Female Coupling (Copper Thread)

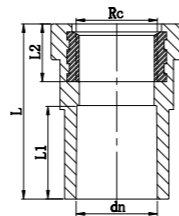
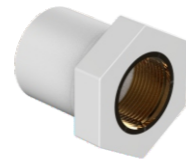

Size (mm)	L (mm)	L2 (mm)	L2 (mm)
40xRc1¼"	63	34	22
50xRc1½"	69	39	22
63xRc2"	80	45	27
75xRc2½"	90.5	50	30
90xRc3"	103	60	33
110xRc4"	115.5	63	39

Male Adapter

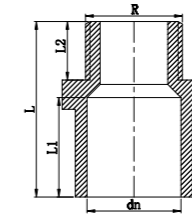

Size (mm)	L (mm)	L1 (mm)	L2 (mm)
20xR½"	42	23	16
25xR½"	45	25	16
25xR¾"	47	25	18
32xR½"	48	28	16
32xR¾"	50	28	18
32xR1"	52	28	20
40xR1¼"	61	34	23
50xR1½"	70	39	24
63xR2"	78	45	28
75xR2½"	92	50	32
90xR3"	106	60	35
110xR4"	115	63	39

Male Adapter

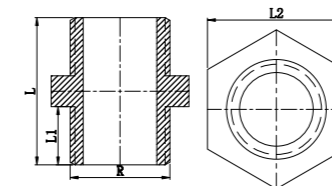

Size (mm)	L (mm)	L1 (mm)	L2 (mm)
R½"	35	13.5	27
R¾"	39	15	33
R1"	44	17	39
R1¼"	55.5	23	52
R1½"	58.5	24	59
R2"	64.5	26	72

Female Adapter

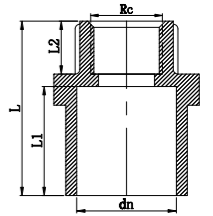

Size (mm)	L (mm)	L1 (mm)	L2 (mm)
20xR½"	45	23	17
25xR½"	45	25	17
25xR¾"	48	25	20
32xR½"	48	28	18
32xR¾"	50	28	20
32xR1"	59	28	21
40xR1¼"	69	35	25
50xR1½"	69	39	25
63xR2"	80	45	28
75xR2½"	89	50	33
90xR3"	102	60	36
110xR4"	116	63	45

Male Plug

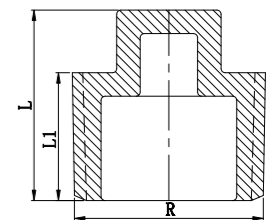

Size (mm)	L (mm)	L1 (mm)
R½"	26	16
R¾"	29	18
R1"	33	21
R1¼"	37	25
R1½"	37	25
R2"	42	29

Reducer



Size (mm)	L (mm)	L1 (mm)	L2 (mm)
25x20	52	25	23
32x20	58	28	23
32x25	58	28	25
40x20	64	34	23
40x25	64	34	25
40x32	67	34	28
50x20	70	39	23
50x25	72	39	25
50x32	75	39	28
50x40	78	39	34
63x25	81.6	45	25
63x32	82.6	45	28

Reducer



Size (mm)	L (mm)	L1 (mm)	L2 (mm)
110x75	131.5	63	50
110x90	133.5	63	60
125x110			
140x125			
160x110	196.5	90	63
160x140			
180x160			

Reducer



Size (mm)	L (mm)	L1 (mm)	L2 (mm)
63x40	87.6	45	34
63x50	91.6	45	39
75x32	93.6	50	28
75x40	97.6	50	34
75x50	102.5	50	39
75x63	103.5	50	45
90x40	110.5	60	34
90x50	115.5	60	39
90x63	116.5	60	45
90x75	117.5	60	50
110x50	120.5	63	39
110x63	126.5	63	45

Reducer



Size (mm)	L (mm)	L1 (mm)	L2 (mm)
200x110	223.5	110	63
200x160	238	110	87
200x180			
225x200			
250x160	272.5	120	100
250x200	279	120	110
250x225			

Compact Ball Valve

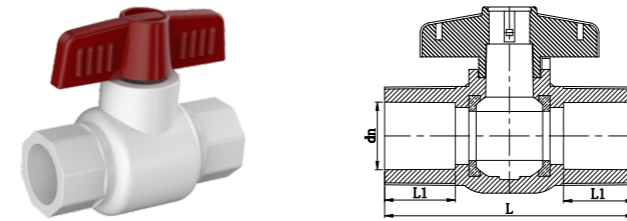

Size (mm)	L (mm)	L1 (mm)
20	76	21
25	95	25
32	119	35
40	131.5	36
50	139	36
63	176	54

Butterfly Valve



Size (mm)
90
110
160
200

Check Valve



Size (mm)	L1 (mm)	L2 (mm)	H (mm)
20	99	20	32
25	102.2	22	32
32	123	26	39

Compact Ball Valve

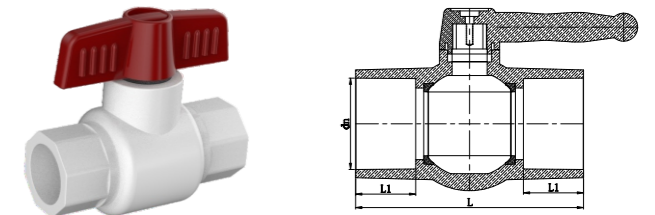

Size (mm)	L (mm)	L1 (mm)
75	224	63
90	259	71
110	284	66
160		

True Union Ball Valve

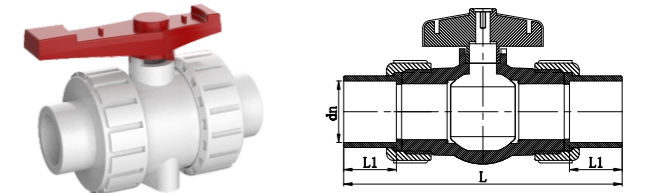

Size (mm)	L (mm)	L1 (mm)
20	104	22
25	110	23
32	125.5	26
40	144.5	30

Foot Valve



Size (mm)	L (mm)	L1 (mm)
32	142	25
40		
50	173	41

Cross

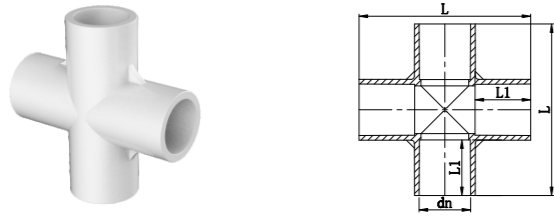

Size (mm)	L (mm)	L1 (mm)
20	70	23
25	79	25
32	94.5	28
40	113.5	34
50	133.5	39
63	160.5	45
75	182	50
90	217.5	60
110	238.5	63

Compression Coupling

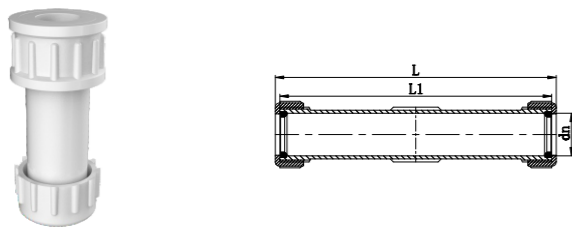

Size (mm)	L (mm)	L1 (mm)
20	122	100.5
25	137	109
32	145	115
40	158	130
50	169	139
63	192	153.5
75	230	193.5
90	266	226
110	304	252
160	330	296

Union

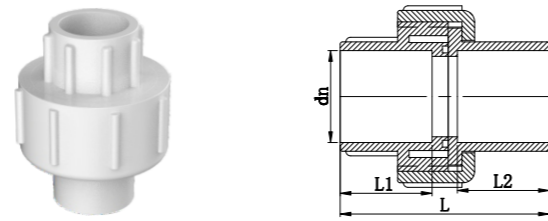

Size (mm)	L (mm)	L1 (mm)	L2 (mm)
20	60	25	25
25	69	30	30
32	84	35	35
40	93	40	40
50	105	45	45
63	127	54	54
75	140	62	62
90	160	72	72
110	145	62	62

Flange

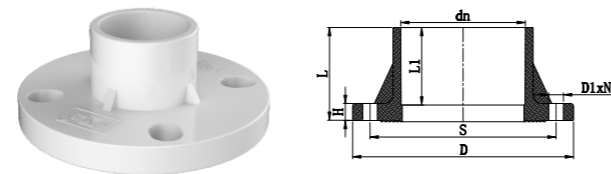

Size (mm)	L (mm)	L1 (mm)	S (mm)	D (mm)	H (mm)	D1xN (mm)
50	55	45	105	139	16	4-Ø16
63	72	55	120	165	17	4-Ø19
75	82	63	140	185	18	4-Ø19
90	92	73	155	200	19	8-Ø19
110	84	63	175	220	20	8-Ø19
160	109	87	236	286	22	8-Ø19
200	135	113	291	333	29	8-Ø23

Flexible Flange

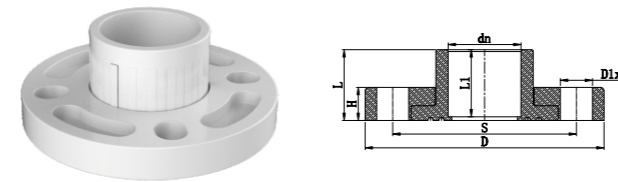

Size (mm)	L (mm)	L1 (mm)	S (mm)	D (mm)	H (mm)	D1xN (mm)
63	61	54	120	164	21	4-Ø19
75	69	62	141	184	28	4-Ø19
90	81	73	155	200	26	8-Ø19
110	71	63	185	231	30	8-Ø19
160	103	89	235	285	30	8-Ø19
200	134	112	290	331	32	8-Ø23
250	172	139	351	404	35	12-Ø26
315	214	179	404	458	45	12-Ø26

Reducer Bushing

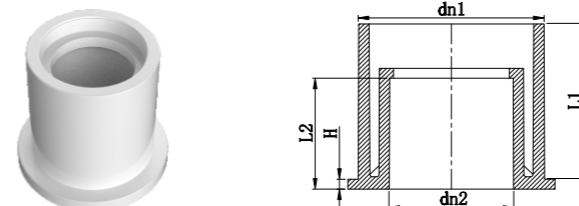

Size (mm)	L1 (mm)	L2 (mm)	H (mm)
25x20	25	23	3
32x20	28	23	3
32x25	28	25	3
40x20	34	23	3
40x25	34	25	3
40x32	34	28	3
50x20	39	23	3
50x25	39	25	3
50x32	39	28	3

Blind Flange

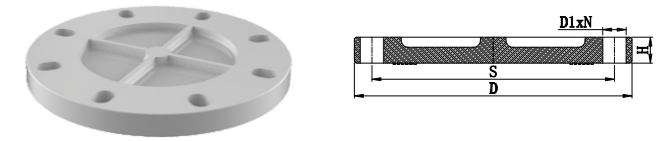

Size (mm)	H (mm)	S (mm)	D (mm)	D1xN (mm)
110	20	175	219.5	8-Ø19
160	24	235	284.5	8-Ø19
200	31	290	331	8-Ø23
250	36	353	404	12-Ø26

Reducer Bushing

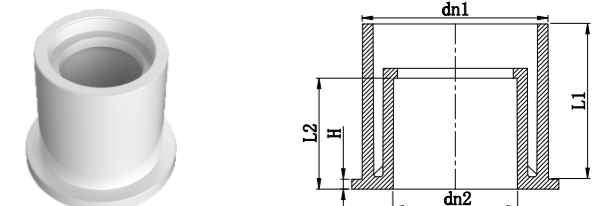

Size (mm)	L1 (mm)	L2 (mm)	H (mm)
50x40	39	34	3
63x25	45	25	4
63x32	45	28	4
63x40	45	34	4
63x50	45	39	4
75x32	50	28	4
75x40	50	34	4
75x50	50	39	4
75x63	50	45	4

Pipe Clamp

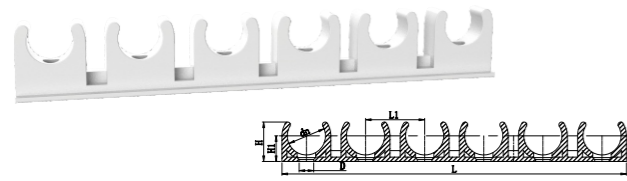

Size (mm)	L (mm)	L1 (mm)	H (mm)	H1 (mm)	D (mm)
20	220	38.5	30	21.5	Ø4.2
25	265	46.5	35.5	26.5	Ø4.2
32	340	60	40	29.5	Ø4.2
40	389	68	52	34.5	8x4.5

Pipe Clamp with Base

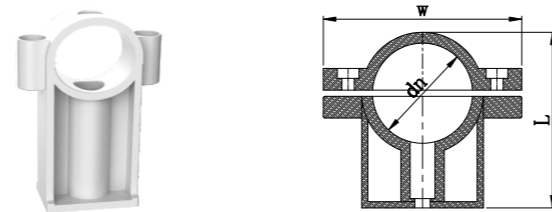

Size (mm)	L (mm)	W (mm)
20	54	36
25	61	43
32	70	53
40	80	66

Pipe Clamp (Screw)

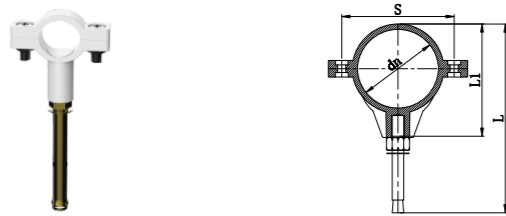

Size (mm)	L (mm)	L1 (mm)	S (mm)
20	97	43	33
25	109	48	40
32	117	56	47
40	128	66	60
50	136	72	70
63	148	85	89
75	155	98	99
90	185	110	118
110	200	135	139
160			
200			

Pipe Clamp(U Style)

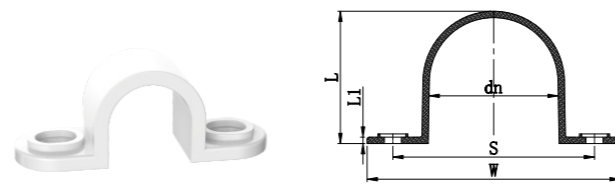

Size (mm)	L (mm)	L1 (mm)	S (mm)	W (mm)
20	23.5	3.5	43	63
25	28	3.5	48	69
32	35	3.5	54	74
40	43	3.5	63	82

Indicators of PVC-U Water Supply Pipe

Color

The color of HOMSO's PVC-U water supply pipes and fittings is usually white, and other colors can be produced according to User's requirements.

Appearance

The product is opaque, the inner and outer surfaces are smooth and clean, no scratches, cracks, bubbles and delamination, no obvious depressions and impurities, no serious cold spots and uneven color, discoloration and other defects.

Length

The standard length of the pipe is 4-6 meters, which can also be agreed by the supplier and the buyer.

Physical and Mechanical Propertie

Item	Test Quota	
	Pipe	Fittings
Density	1350-1460kg/m ³	
Vicat Softening Temperature	≥80°C	≥74 °C
Longitudinal Retraction Rate	≤5%	
Soaking in Dichloromethane(15°C,15min)	The urface change is not inferior to 4L	
Oven Test		Conformto GB/T8803-2001
Falling Weight Impact Test	≤5%	
Hydraulic Pressure Test	No rupture,no leakage	No rupture,no leakage
System Suitability Test	No rupture,no leakage	No rupture,no leakage
Drop Test		No rupture

Hygienic performance

- 1.The product does not give the tap water a smell, taste and color
- 2.The sanitary properties of pipes and fittings for transporting drinking water meet the standard GB/T17219-1998
- 3.The content of vinyl chloride monomer in pipes and fittings for drinking water shall not exceed 1.0 mg/kg.

Instructions

When connecting the HOMSO water supply pipe, the small-diameter pipe is connected by pipe fittings, and the large-diameter pipe can be connected by the pipe material or the socket rubber ring; when using the pipe fittings, it is necessary to use hygienic non-toxic adhesive the company supplies.

